

Model No's.

ACSPR-SEQ4-1509

rocker
switch

ACSPR-SEQ4-1509K

key
switch



Rackmount panels with 15A outlets, 4-step sequencer, surge protection

Slim (1U) 19"W rackmount panels feature 15A power outlets and a four step sequencer for time-delayed activation/deactivation of equipment directly plugged into the six (6) switched outlets. Three (3) additional outlets are unswitched (always on). Includes surge suppressor and alarm interface.



Features

- Power rating 120VAC 60Hz/15A with EMI/RFI filtering
- Terminates with 9 ft. cord and NEMA 5-15P plug
- Front rocker or key switch (on/off)
- One front and two rear unswitched outlets (always on); six rear switched outlets (activated by on/off switch)
- Four-step sequencer has a delay between steps that can be set between 0.5 and 10 seconds (screwdriver adjustable)
- Color coded LED status indicators
- Rear terminal block for connection to optional remote switches (momentary).
- Rear terminal block to allow system switches to be overridden for life safety system applications where fire code mandates an alarm interface.
- Surge protector — UL1449 fourth edition and ANSI C62.41 compliant. Defeats surges up to 72,000A.
- ETL Listed in the US and Canada UL Standard 60065
- Made in the U.S.A.

- Alarm Interface: Lock on, lock off and switch lock for alarm system or master control panel applications.
- External Control Connections: Plug-in barrier strip terminal blocks
- Termination: 9 ft. attached cord with NEMA 5-15P plug
- EMI/RFI Filter: 19dB@500kHz, 42dB@30MHz
- Front Receptacle: One single unswitched (always on)
- Rear Receptacles: Two single unswitched (always on)
One single switched (step 1)
One single switched (step 2)
One duplex switched (step 3)
One duplex switched (step 4)
- Step Delay: 0.5–10 seconds between steps. Screwdriver adjustable.
- Chassis: Steel with black powder epoxy finish.
19"W x 1.75"H (1U) x 9"D (12 lbs.)
- Agency Approvals: ETL Listed in US and Canada to UL Standard 60065 "Audio, Video and Similar Electronic Apparatus"

A & E Specifications

The 1U rackmount panel with nine 15A power outlets (one unswitched in front, two unswitched in rear, six switched in rear), surge suppressor, and four-step sequencer shall be Lowell Model No. _____ (ACSPR-SEQ4-1509, ACSPR-SEQ4-1509K). It shall be ETL Listed and have a power rating of 120VAC 60Hz/15A with EMI/RFI filtering. The front switch shall sequentially activate and deactivate equipment connected to the "switched" rear outlets in four steps. The sequence delay between steps shall be between 0.5 to 10 seconds, which shall be screwdriver adjustable. Surge suppressor shall be UL1449 fourth edition and ANSI C62.41 compliant to defeat surges up to 72,000A. The steel chassis shall have a black finish and feature color coded LEDs and a _____ (rocker, key) activation switch on the front. Overall measurements shall be 19"W x 1.75"H x 9"D. Termination shall be via a 9 ft. cord with NEMA 5-15P plug.

Specifications

- Power Rating: 120VAC, 60Hz, 15A 1800W
- Actuation Switch: Front rocker or key switch with momentary contacts (normally open SPST) plus rear barrier strip termination blocks for momentary (normally open) remote switches.

Three Stage Surge Protector:

- Maximum Surge Current: 72,000A (exceeds UL1449-4 6000V, 3000A)
- Initial Clamping Voltage: 205V, UL rating 400V
- Endurance: IEEE C62.41-1991, B3 (C1), Pulses (lifetime):
1kv≥1,000,000; 3kv≥100,000; 6kv≥5,000
- Transient Noise Reduction: 25dB@100kHz, 50dB@1MHz
- Response Time: Less than 5 nanoseconds
- Protection Mode: Line to neutral, zero ground leakage
- UL1449-2 Adjunct Results: 1000 surges, 6000 volts, 3000A, C1 and B3 waveforms (IEEE C62.41), No failures
- Diagnostic LEDs: One green LED for each stage*
All stages active when all lit
- Applicable Standards: IEEE standard 587-80 A & B, IEEE standard C62.41-1991, IEC 1000-4-5-1995 (IEC 801-5).

* Lowell's Triple Clamping Redundancy (TCR) is exactly that — triple clamping for triple protection. This means that if one section of the suppressor has gone off-line there are two additional sections available to safeguard equipment. Device is endurance tested.

Note: Formerly Model No's. ACSPR-SCS4-1509, ACSPR-SCS4-1509K

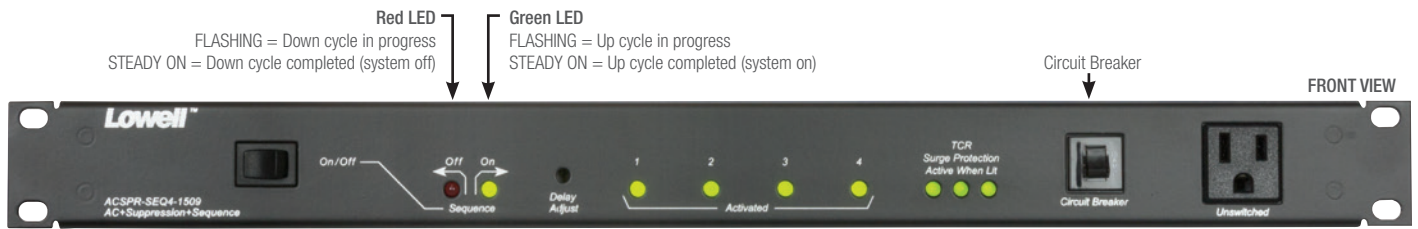

Red LED
FLASHING = Down cycle in progress
STEADY ON = Down cycle completed (system off)

Green LED
FLASHING = Up cycle in progress
STEADY ON = Up cycle completed (system on)

Rocker Switch
activation

Delay - recessed trim pot with screwdriver adjust

Green LEDs - indicate progress of Up and DOWN sequence

Green LEDs - three stage surge protection, active when lit



Includes 9-ft. attached cord with NEMA 5-20P plug

ALARM SYSTEM INTERFACE

If required by local building code, facility usage, or the Fire Marshal; the system switches can be overridden and the system controlled by contact closures provided by the fire alarm panel or other similarly installed device. A maintained contact between the 'com' terminal and any of the terminals shown will provide the following functions.

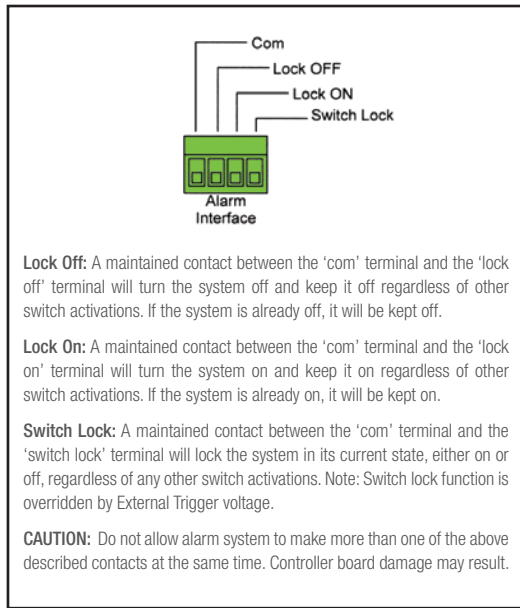

Maximum wire distances
24ga.: 20,000 ft. (approx. 3.5 miles), 22ga.: 31,200 ft. (approx. 5.5 miles),
18ga.: 76,800 ft. (approx. 13.5 miles)

REMOTE SWITCH CONNECTIONS

Unit may be controlled using a MOMENTARY closure switch that is remotely located (order separately).

