



cinema
connect



CINEMA CONNECT

The solution for 100% inclusion in your cinema.
Reach out to all audiences, and generate genuine added value.

OUR VISION OF INCLUSION

Whether with a sensory impairment or speaking other languages, everyone can see the same movie – with no effort for cinema operators, and with a maximum protection against piracy.





BRING YOUR OWN DEVICE

More and more people use a smartphone. By the end of 2014 there were over 1.63 billion users worldwide!

As permanent companions, they are used everywhere.

This can also benefit you as a cinema operator.

No rentals and no maintenance of external devices.

Your visitors use CinemaConnect on their smartphones, and you do not need to lend any device. Maintenance and personnel costs are no longer an issue, and your guests customize the app to suit their needs.

Our CinemaConnect app

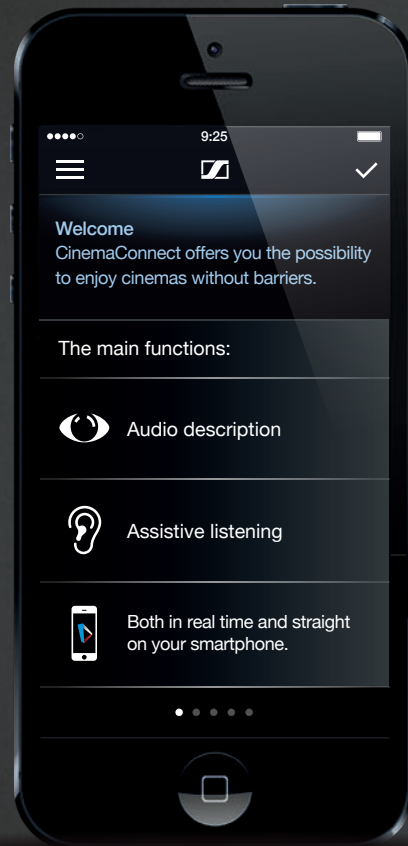

Main Functions

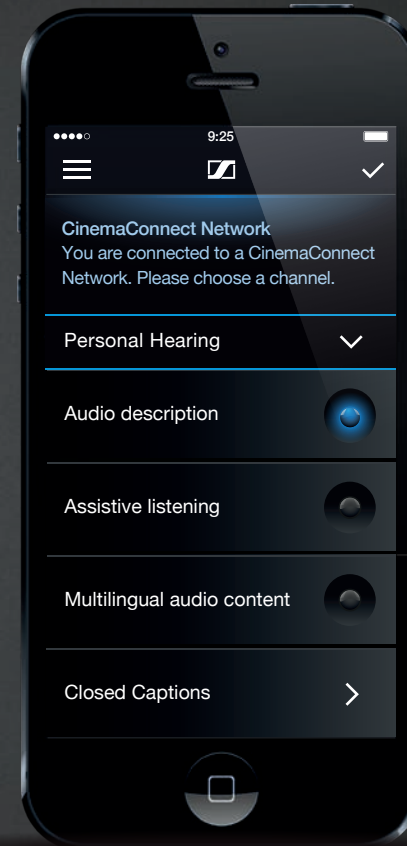

Channel Selection

Personal Hearing

Customised assistive listening for your guests.

Not only the volume of the received audio signal can be customized, but also intelligibility and sound quality can be optimised to suit individual hearing needs.

This technology was developed by the Hearing, Speech and Audio Technology project group at IDMT, the Fraunhofer Institute for Digital Media Technology.

The Fraunhofer researchers have developed an intuitive user interface, so that users can easily adjust the audio signal themselves: Users can change the setting by touching the touch-sensitive selection area until they receive a clear sound.



Personal Hearing

At a glance



AUDIO DESCRIPTION

Crystal clear audio description, very easy to understand, for people with visual impairments



HEARING ASSISTANT

Customizable audio transmission for people with hearing impairments



ASSISTIVE LISTENING

Best support for viewers with hearing impairments, e.g. hearing aid wearers



CLOSED CAPTIONS

Closed Captions or subtitles directly on the smart device, very easy to read, for people with hearing impairments



MULTILINGUAL AUDIO CONTENT

Parallel transmission of foreign language versions of the same movie*

* Depending on whether foreign language versions of the movie are provided.

OUR SYSTEM

With CinemaConnect, we have developed a system for your cinema which enables real-time transmission of audio content to mobile devices such as smartphones and tablets.

Our streaming server and the CinemaConnect app accomplish the prerequisites for audio description, hearing assistance, transmission of multilingual audio content, alternative content, and many other benefits for your cinema operations.

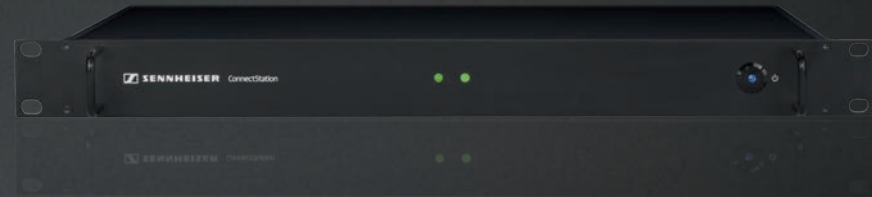

ConnectStation is a WLAN-based multi-channel audio transmission system for mobile devices. The system can be used wherever audio is transmitted.

Live content and additional services, such as geo-location, text, and real-time images are transmitted to user's devices via the ConnectStation.



SIMPLE SYSTEM MANAGEMENT



INTUITIVE OPERATION

This is how our streaming technology works:

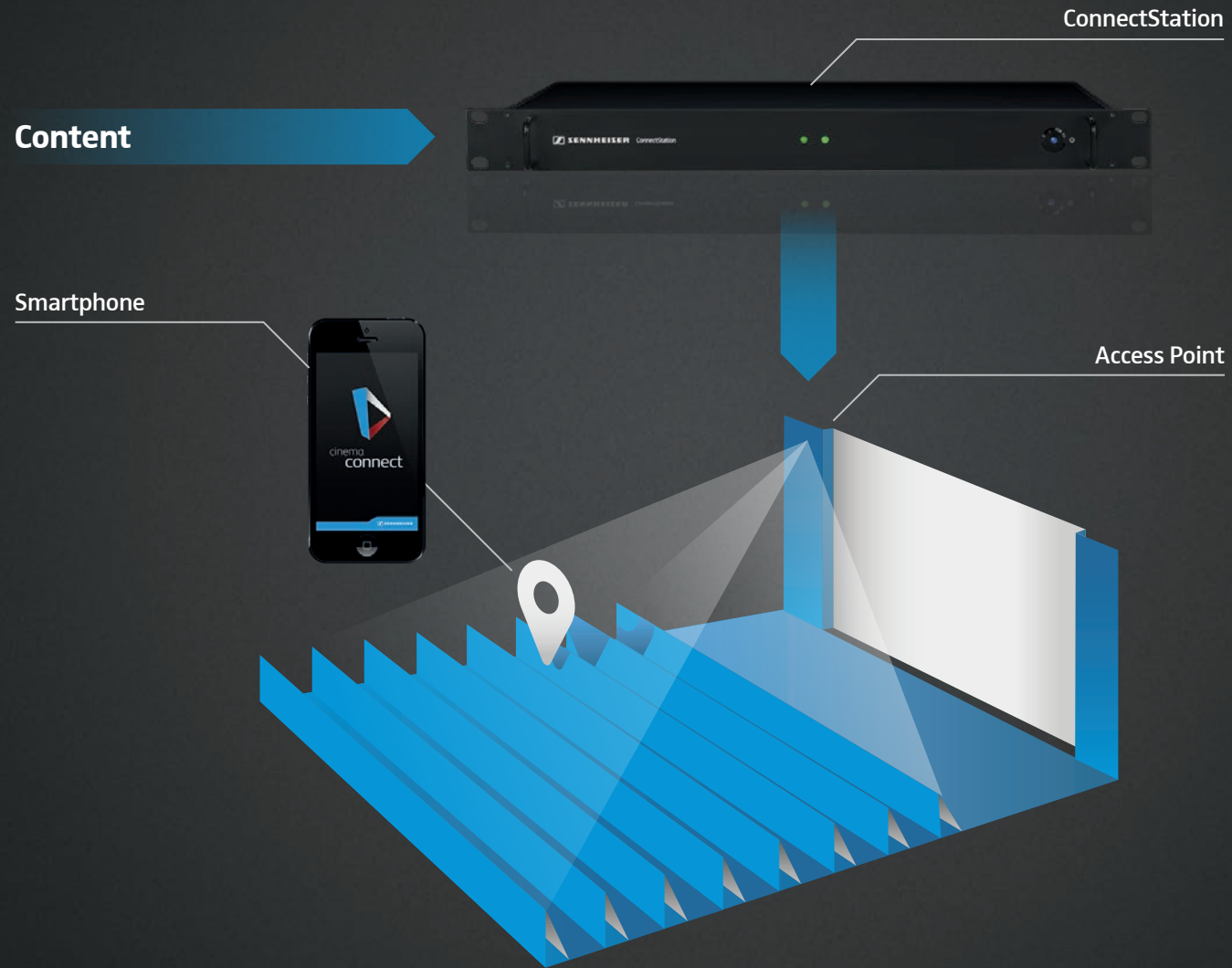

Specifications

ConnectStation CS1-C

Dimensions W x D x H	48,3 x 24 x 4,4 cm 19.0" x 9.5" x 1.7"
Weight	2.9 kg (6.39 lbs)
Voltage	100 - 240 V AC, 50/60 Hz
Power	60 W nominal
Operating temperature	+5 °C to +45 °C (41°F to 113 °F)
Storage temperature	-20 °C to +75 °C (-4°F to 167 °F)
Operating humidity range	10-90% @ 25 °C non-condensing
Storage humidity range	5-95% @ 25 °C non-condensing

Analog In



Resolution AD	24 Bit
Sample rate	48 kHz
Signal to Noise Ratio (SNR)	113 dB RMS unweighted 116 dbA @ 44.1 kHz
THD	< -110 dB, < 0.00032%
THD+N	< -104 dB, < 0.00063%
Crosstalk	> 110 db
Frequency response @ 44.1 kHz, -0.5 dB	5 Hz to 21.5 kHz
Input type	4 times 1/4" TRS jack, servo balanced
Input impedance	10 k Ω
Input sensitivity	Low gain, +4 dBu, -10 dBV
Input level for 0 dBFS @ low gain	+19 dBu
Input level for 0 dBFS @ +4 dBu	+13 dBu
Input level for 0 dBFS @ -10 dBV	+2 dBV

SPDIF / AES



Inputs type	1 x RCA (XLR), transformer balanced, galvanically isolated, according to AES3-1992
SPDIF compatible	IEC 60958
Lock range	27 to 200 kHz
Connection type	AES3-1992
Connection	XLR balanced (not included in delivery)
Impedance	110 k Ω
Level	0.2 V up to 5 Vss
Connection type	SPDIF (IEC60958)
Connection	RCA / Optical unbalanced
Impedance	75 Ω
Level	0.2 V up to 5 Vss

Analog Breakout



Resolution AD	24 Bit
Signal to Noise Ratio (SNR)	109 dB RMS unweighted 111 dbA @ 44.1 kHz
THD	-101 dB, < 0.001%
THD+N	< -99dB, < 0.0015%
Crosstalk	108 db
Frequency response AD @ 44.1 kHz, -0.5 dB	5 Hz to 21.5 kHz
Input type	phono unbalanced
Input impedance	10 k Ω
Input sensitivity	Low gain, +4 dBu, -10 dBV
Input level for 0 dBFS @ low gain	+19 dBu
Input level for 0 dBFS @ +4 dBu	+13 dBu
Input level for 0 dBFS @ -10 dBV	+2 dBV

ADAT/ SPDIF



Input	TOSLINK
Standard	8 channels, 24 bit - 48 kHz
Sample split (S/MUX)	4 channels, 24 bit, 96 kHz
Lock range	31.5 to 50 kHz

CONTACT

Sennheiser Electronic Corp.

One Enterprise Drive

Old Lyme, CT 06371

USA

Tel.: +1 860 434-9190

Sennheiser (Canada) Inc.

221 Labrosse Av.

Pointe-Claire, Quebec, H9R 1A3

Canada

Tel.: +1 514 426-3013

E-Mail: info@sennheiser-connect.com

URL: sennheiser.com

cinema
connect



 SENNHEISER