

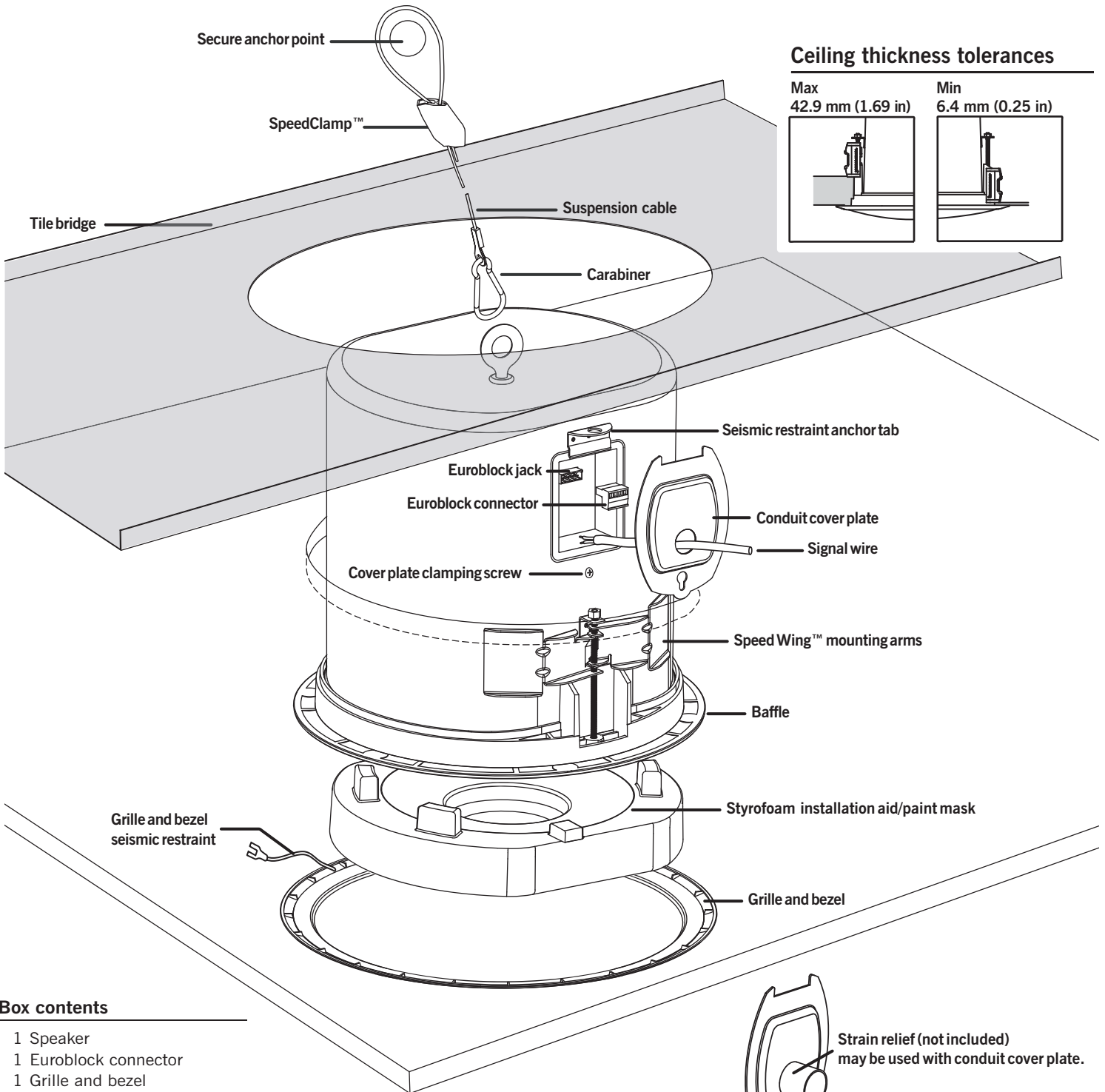

**CMi Series** | Install Instructions For:  
CM800d, CM890d and CM1001d speakers



**Box contents**

- 1 Speaker
- 1 Euroblock connector
- 1 Grille and bezel
- 1 Styrofoam installation aid/paint mask
- 1 Conduit cover plate
- 1 Tile bridge
- 1 Suspension cable

1.435.647.9555 | 800.647.TUBE | www.soundtube.com

**CM800d, CM890d, and CM1001d- UL listed 1480 & 2043**

© 2008 SoundTube Entertainment, Inc. All rights reserved. PN INS-CMd Rev09.15.08

**Warning**

SoundTube speakers must be installed by a professional audio installer/contractor. For safety and for optimum audio performance, installer must follow all directions issued by SoundTube Entertainment.

**Warning**

Do not spec or install speaker near support beam, ventilation duct or other structure that may interfere with speaker function or dispersion.

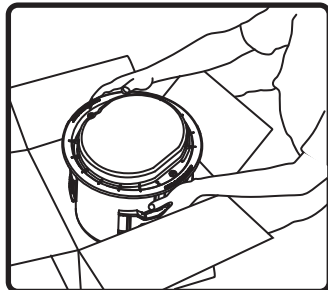

1. Unpack speaker & set aside grille assembly.

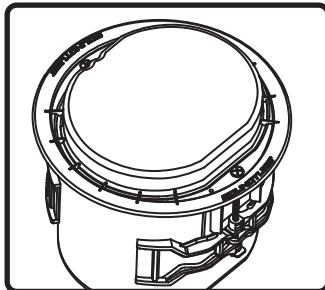

2. Keep Styrofoam installation aid/paint mask attached to speaker until speaker installation is complete.

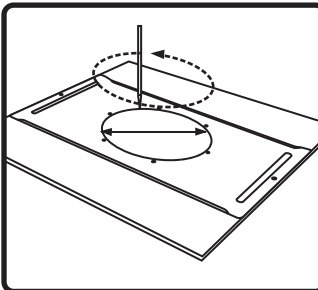

3. Use included tile bridge to mark cutout in tile.

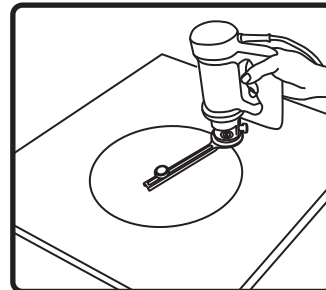

4. Use Rotozip or other tool to cut hole. Hole diameter 325.1 mm (12.80 in)

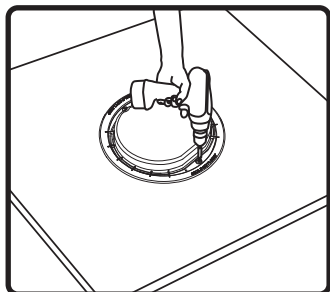

5. Insert speaker into mounting hole on ground with installation aid in place. Tighten both bolts located on the baffle face to actuate the mounting wings. Firmly secure both sides – **do not over-tighten**. Replace assembled tile and speaker into tile grid.

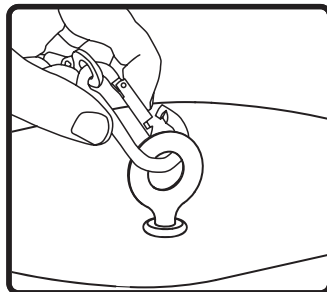

6. For added support attach eyelet end of suspension cable to the rear of speaker using the carabiner. Attach the other end of support cable to secure structure using speedclamp. If required, attach the seismic restraint system to the sheet-metal tab on the side of speaker (seismic restraint not included).

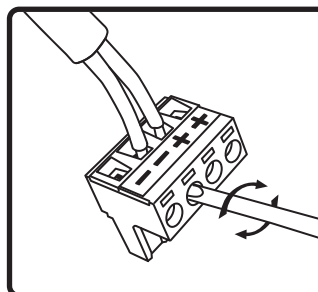

7. Thread signal wire through conduit cover plate. Connect signal wire to 4-pin Euroblock plug. Tighten unused terminal screws. Use inside positive and negative inputs for either voice coil or distributed systems. For daisy chaining, use outside positive and negative terminals. Euroblock must be plugged in for daisy chain to function.

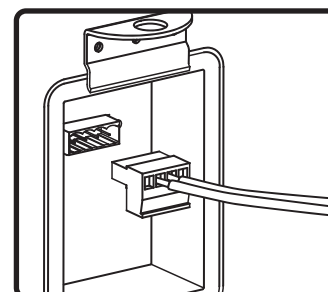

8. Insert the Euroblock plug into the Euroblock jack on side panel of speaker and replace conduit cover plate. **For UL-compliant installations strain relief (not supplied) may be inserted into hole in conduit cover plate.**

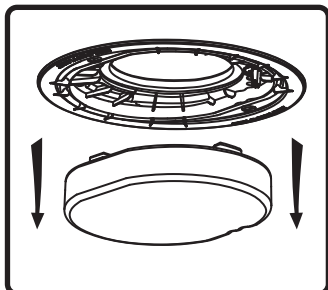

9. If you are not painting the ceiling, remove & discard the paint mask.

10. If you are painting the ceiling after the speaker is installed, leave the paint mask in place until paint is dry.

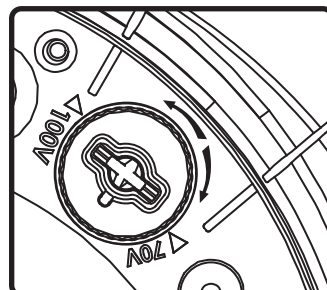

11. Select the tap position by adjusting rotary switch to desired high impedance value or voice coil bypass mode. Switch is preset to maximum tap setting in 70.7 V mode.

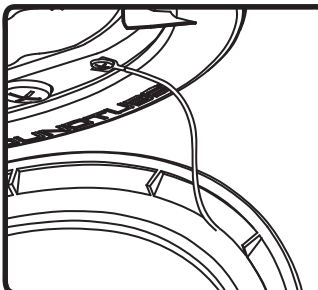

12. Attach grille & bezel seismic restraint to baffle with provided screw .

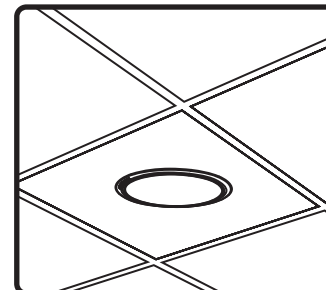

13. Attach grille – position the grille over the baffle and allow magnets to attract grille into place. Be sure grille is properly centered over baffle.

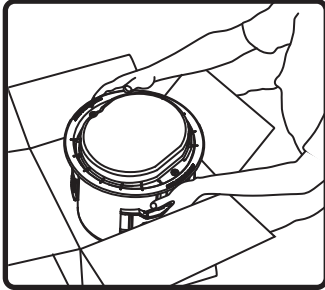

**1.** Unpack speaker & set aside grille assembly.

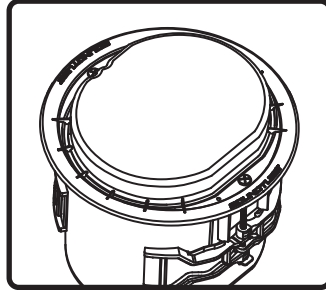

**2.** Keep Styrofoam installation aid/paint mask attached to speaker until speaker installation is complete.

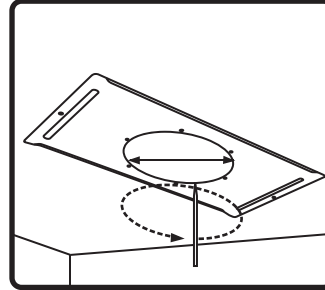

**3.** Use included tile bridge to mark cutout in sheetrock.

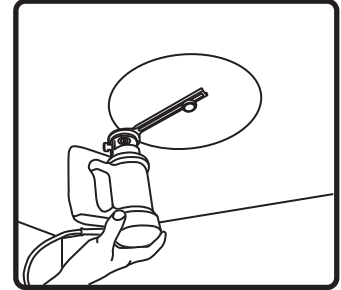

**4.** Use Rotozip or other tool to cut hole. Hole diameter 325.1 mm (12.80 in)

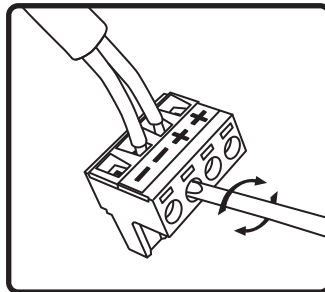

**5.** Thread signal wire through conduit cover plate. Connect signal wire to 4-pin Euroblock plug. Tighten unused terminal screws. Use inside positive and negative inputs for either voice coil or distributed systems. For daisy chaining, use outside positive and negative terminals. Euroblock must be plugged in for daisy chain to function.

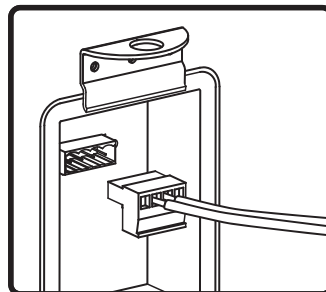

**6.** Insert the Euroblock plug into the Euroblock jack on side panel of speaker and replace conduit cover plate. **For UL-compliant installations strain relief (not supplied) may be inserted into hole in conduit cover plate.**

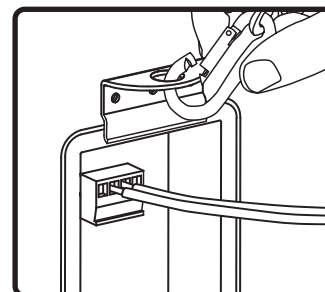

**7.** If seismic restraint is required, attach the suspension cable to sheet-metal tab on the side speaker.

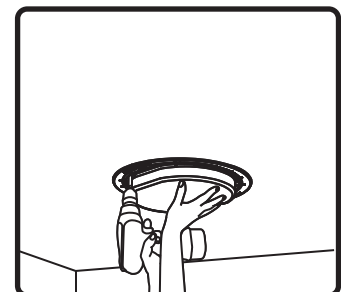

**8.** Insert speaker into mounting hole with installation aid in place. Tighten both bolts located on the baffle face to actuate the mounting wings. Firmly secure both sides – **do not over-tighten.**

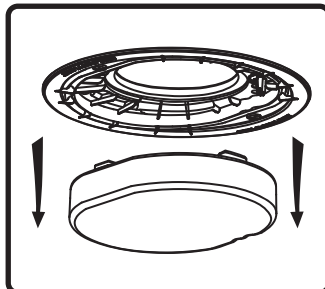

**9.** If you are not painting the ceiling, remove & discard the paint mask.

**10.** If you are painting the ceiling after the speaker is installed, leave the paint mask in place until paint is dry.

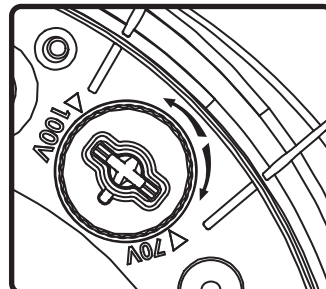

**11.** Select the tap position by adjusting rotary switch to desired high impedance value or voice coil bypass mode. Switch is preset to maximum tap setting in 70.7 V mode.

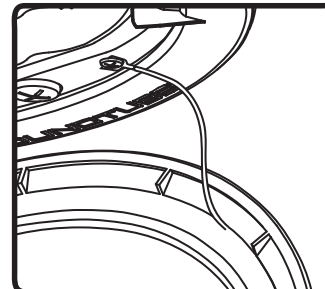

**12.** Attach grille & bezel seismic restraint to baffle with provided screw.

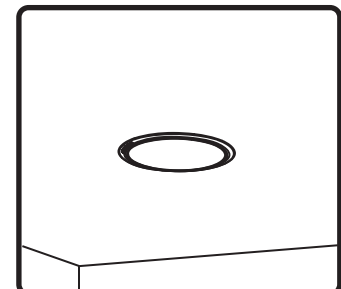

**13.** Attach grille – position the grille over the baffle and allow magnets to attract grille into place. Be sure grille is properly centered over baffle.

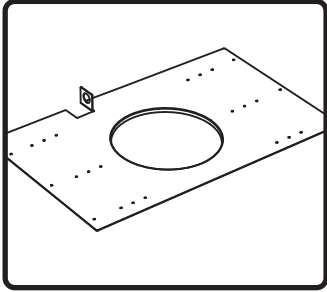

1. Nail or screw bracket to joists. Secure cover plate and conduit away from hole in bracket.

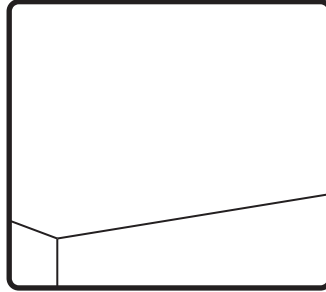

2. Complete Finish work.

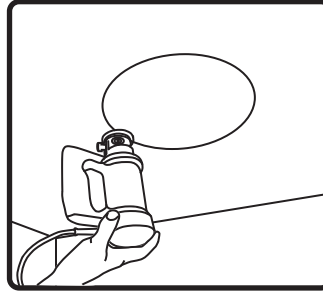

3. Use Rotozip or other tool to cut hole.

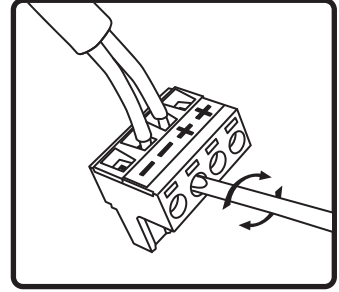

4. Thread signal wire through conduit cover plate. Connect signal wire to 4-pin Euro-block plug. Tighten unused terminal screws. Use inside positive and negative inputs for either voice coil or distributed systems. For daisy chaining, use outside positive and negative terminals. Euroblock must be plugged in for daisy chain to function.

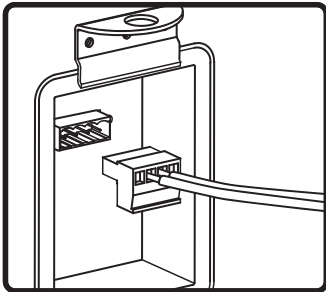

5. Insert the Euroblock plug into the Euroblock jack on side panel of speaker and replace conduit cover plate. **For UL-compliant installations strain relief (not supplied) may be inserted into hole in conduit cover plate.**

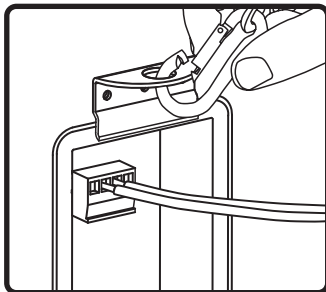

6. If seismic restraint is required, attach the suspension cable to sheet-metal tab on the side speaker.

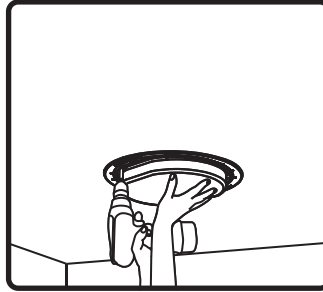

7. Insert speaker into mounting hole with installation aid in place. Tighten both bolts located on the baffle face to actuate the mounting wings. Firmly secure both sides – **do not over-tighten.**

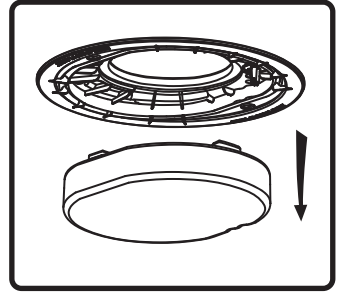

8. **If not painting** the ceiling, remove & discard the paint mask.  
9. **If painting** the ceiling after the speaker is installed, leave the paint mask in place until paint is dry.

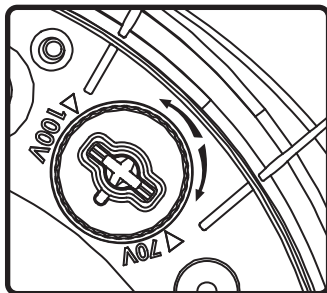

10. Select the tap position by adjusting rotary switch to desired high impedance value or voice coil bypass mode. Switch is preset to maximum tap setting in 70.7 V mode.

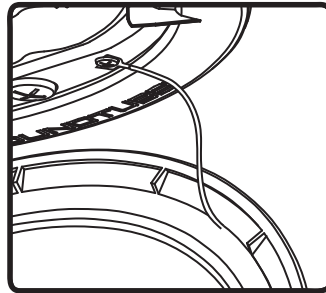

11. Attach grille & bezel seismic restraint to baffle with provided screw.

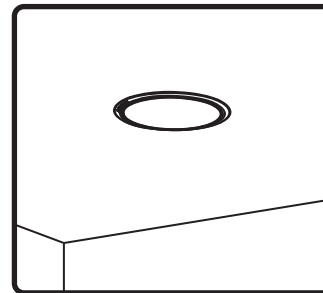

12. Attach grille – position the grille over the baffle and allow magnets to attract grille into place. Be sure grille is properly centered over baffle.