

DVS Series

Stylish Surface Mount **Loudspeakers**



TANNOY

Operation Manual

Table of Contents

1. Introduction.....4

2. Safety Instructions.....4

3. Product Feature Identification.....5

4. Standard Accessories.....6

5. Installation Guidelines.....7

6. DVS Dimensions.....8

7. Technical Specifications11

8. Warranty.....14

1. Introduction

Designed for a wide variety of sound reinforcement applications the Tannoy DVS is an ultra compact loudspeaker system capable of delivering high sound pressure levels with extremely low distortion, resulting in outstanding clarity, definition and detail. A truly universal solution, the DVS offers outstanding durability and resistance to scuffs and knocks. Able to deliver consistent performance under a wide range of adverse conditions the DVS is suited to applications indoors or out. Available in black or white the DVS will effectively blend into most backgrounds. Utilisation of the point source loudspeaker allows the DVS to be mounted on a wall or ceiling in either horizontal or vertical orientations without affecting its performance. A range of hardware options ensures simple and effective installation. Only available with built-in line transformer. For applications requiring extended low frequency enhancement, a range of Tannoy sub-bass systems are available and can be used in conjunction with the DVS.

2. Safety Instructions

1. Read these instructions.
2. Keep these instructions.
3. Heed all warnings.
4. Follow all instructions.
5. The user is responsible for fixing the hardware to the surface to ensure safe operation. The fixings must support the weight of the product – please consult the manual's specification page for the appropriate weights. Please consult the relevant construction codes in your region for further information on suitable hardware fixing methods.

Tannoy will not be held responsible for any damages caused by the improper installation of these loudspeakers.

3. Product Feature Identification



INPUT CONNECTOR
Fit rubber grommet to ensure the rear of the product is kept sealed



4. Standard Accessories

DINKLE SEAL



YOKE BRACKET
(SUPPLIED WITH
FIXINGS)

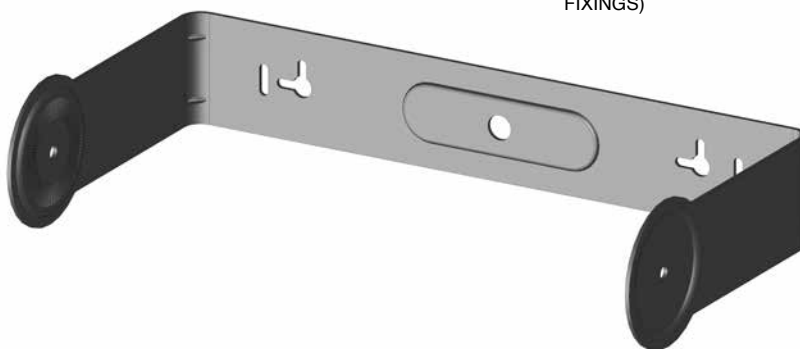

5. Installation Guidelines

1. Fix the yoke bracket to the surface using a suitable fixing method. (Fig.1)
2. Feed the speaker cable through the cable clamp cover then connect the Euro-type plug to the wires, observing the correct polarity. (Fig.2)
3. For connection to the loudspeaker, use Pins 1 (+) and 2 (-). Pins 3 (-) and 4 (+) are in parallel for connection to additional speakers in a distributed line. (Fig.3)
4. Offer the speaker up to the bracket and attach using the thumb screws provided (Fig.4)
5. Connect the Euro-type plug then replace the rubber grommet to ensure the speaker is sealed. (Fig.5)
6. The DVS 4t models are fitted with 30 W transformers. (Fig.6)

THE SPEAKER IS SUPPLIED IN LOW IMPEDANCE MODE.
NEVER CONNECT THE SPEAKER TO A 70/100 VOLT AMPLIFIER WHILE IT IS SET FOR LOW IMPEDANCE.

7. The DVS 6t and DVS 8t models are fitted with 60 W transformers. (Fig.7)

THE SPEAKER IS SUPPLIED IN LOW IMPEDANCE MODE.
NEVER CONNECT THE SPEAKER TO A 70/100 VOLT AMPLIFIER WHILE IT IS SET FOR LOW IMPEDANCE.



Fig.1



Fig.2

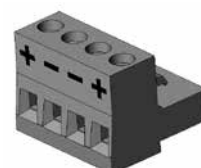

Fig.3



Fig.4



Fig.5



Fig.6

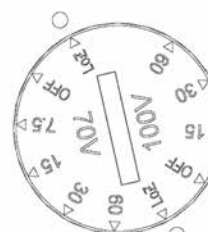
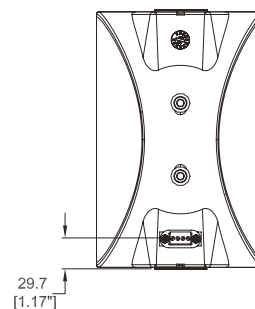
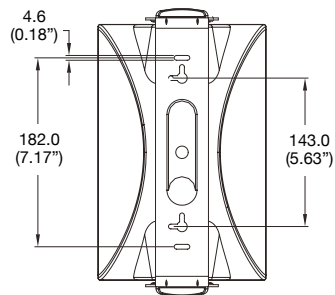
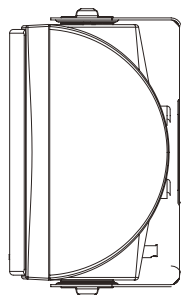
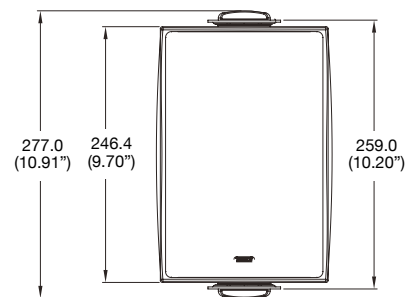
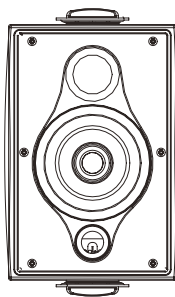
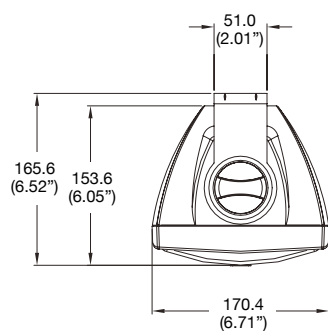

Fig.7

6. DVS Dimensions

DVS 4



6. DVS Dimensions

DVS 6

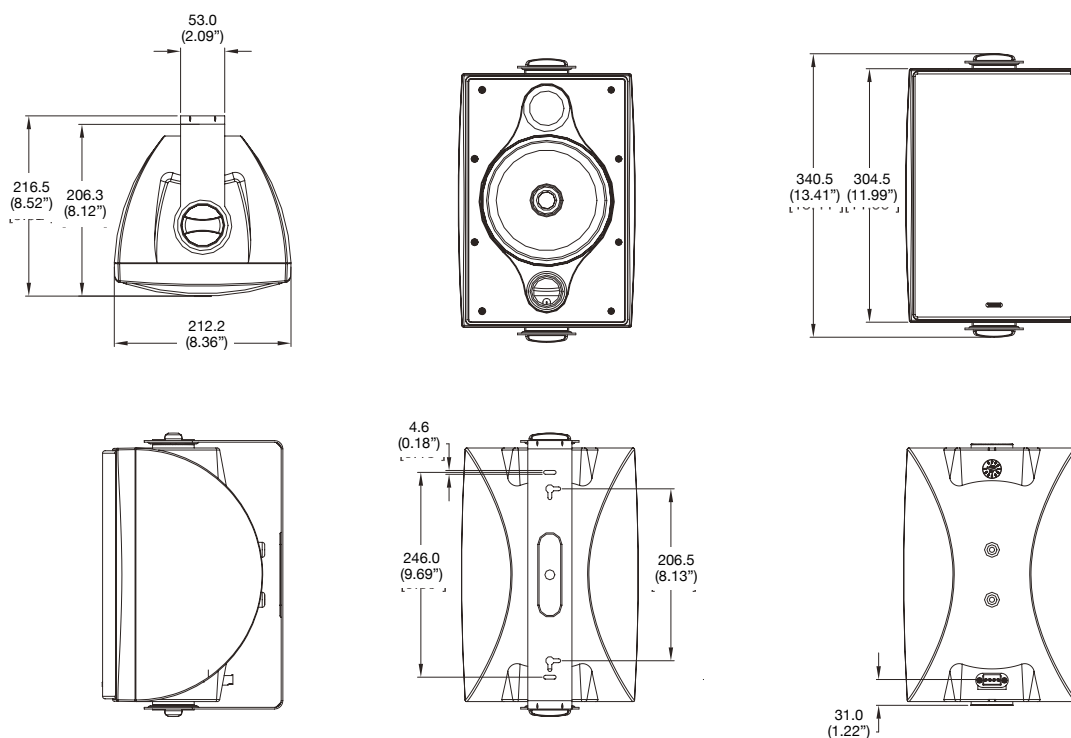

6. DVS Dimensions

DVS 8

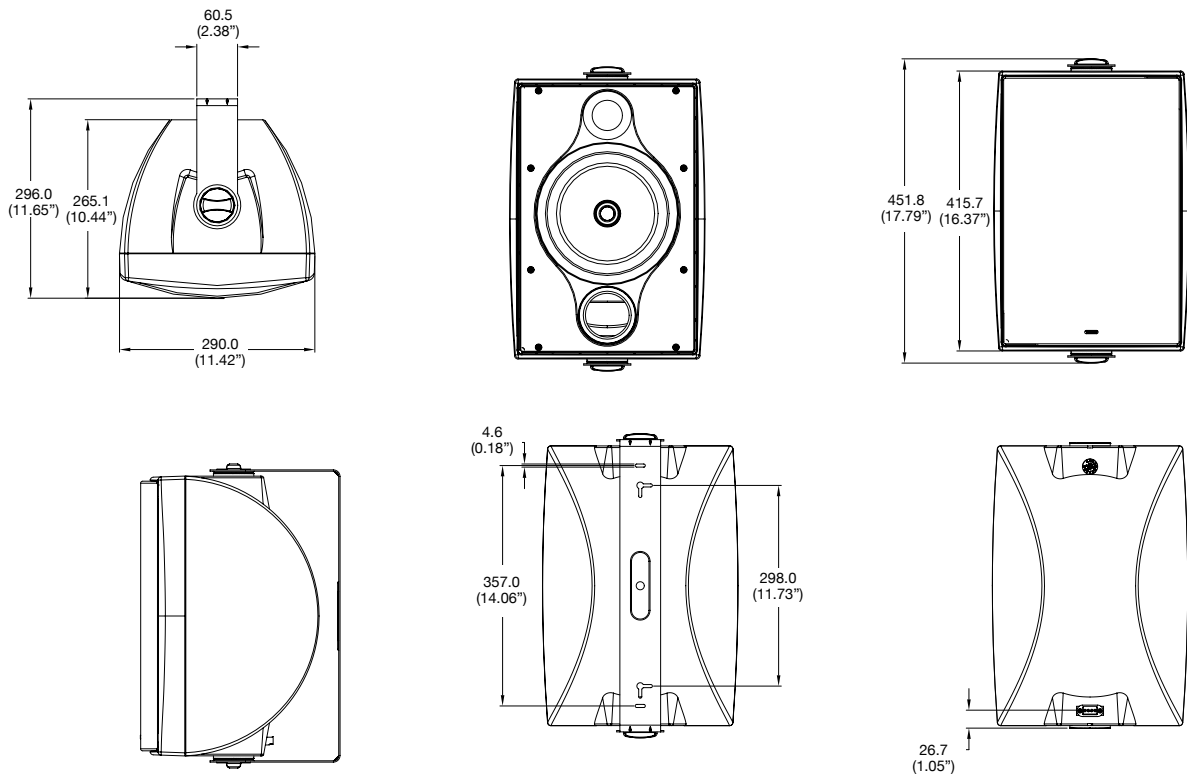

7. Technical Specifications

DVS 4/DVS 4t Model

Performance	
System	DVS 4
Frequency response (-3 dB) ⁽¹⁾	75 Hz - 20 kHz
Frequency range (-10 dB) ⁽¹⁾	60 Hz - 30 kHz
Rated sensitivity (1W @ 1m) ⁽²⁾	84 dB
Dispersion (-6 dB)	110 degrees conical
Directivity factor (Q)	6.5 averaged 1 kHz to 10 kHz
Directivity Index (DI)	5.3 averaged 1 kHz to 10 kHz
Power Handling	
Average	40 W
Programme	80 W
Peak	160 W
Recommended Amplifier Power	80 W @ 6 ohms
Nominal Impedance (Lo, Z)	6 ohms
Rated maximum SPL (1 m, Lo Z) ⁽²⁾	
Average	100 dB
Peak	106 dB
Crossover Point	3.9 kHz - 2nd order LF, 2nd order HF

Distortion			
10% full power (4.9 V)		Harmonics	
		2nd	3rd
	250 Hz	0.738%	0.772%
	1 kHz	0.145%	0.234%
	10 kHz	0.070%	0.070%
1% full power (1.55 V)			
	250 Hz	0.320%	0.311%
	1 kHz	0.078%	0.174%
	10 kHz	0.087%	0.087%

Transducers	
Low Frequency	100 mm (4.00") mineral loaded cone material
High Frequency	19 mm (0.75")

Physical	
Enclosure	ABS
Grille	Aluminium, Painted
Connectors	Euroblock type removable locking connector with screw terminals with "loop through" facility
Transformer Setting	Rotary switch
Dimensions (H x W x D)	277.0 x 170.4 x 165.6 mm (10.91" x 6.71" x 6.52")
Net Weight (ea)	1.8 kg (3.96 lbs)
Shipped weight	5.4 kg (11.9 lbs)
Supplied Accessories	Yoke bracket
Packed Quantity	2

Transformer Version (specifications as above except)	
Transformer Taps (via front rotary switch)	
70 V	30 W (165 Ω) / 15 W (330 Ω) / 7.5 W (660 Ω) / 3.75 W (1320 Ω) / OFF & low impedance operation
100 V	30 W (330 Ω) / 15 W (660 Ω) / 7.5 W (1320 Ω) / OFF & low impedance operation
Maximum wire gauge for connector	2.5 mm ² CSA (AWG12)
Safety Agency Ratings	UL-1480, CE
Net Weight (ea)	2.3 kg (5.07 lbs)
Shipped Weight	6.2 kg (13.66 lbs)

Ordering Information	
Part Number	Colour
8001 6710 DVS 4	Black
8001 6711 DVS 4	White
8001 6720 DVS 4t	Black
8001 6721 DVS 4t	White



Notes:

1. Average over stated bandwidth. Measured at 1 metre on axis in an Anechoic Chamber
2. Unweighted pink noise input, measured at 1 metre in an Anechoic Chamber

A full range of measurements, performance data, CLF and Ease™ Data for DVS 4 can be downloaded from www.tannoypro.com.

Tannoy operates a policy of continuous research and development. The introduction of new materials or manufacturing methods will always equal or exceed the publishing specifications, which Tannoy reserves the right to alter without prior notice. Please verify the latest specifications when dealing with critical applications.

Copyright (c) 2016 Tannoy Limited. All rights reserved.

7. Technical Specifications

DVS 6/DVS 6t Model

Performance	
System	DVS 6
Frequency response (-3 dB) ⁽¹⁾	80 Hz - 20 kHz
Frequency range (-10 dB) ⁽¹⁾	65 Hz - 30 kHz
Rated sensitivity (1W @ 1m) ⁽²⁾	88 dB
Dispersion (-6 dB)	90 degrees conical
Directivity factor (Q)	10.6 averaged 1 kHz to 10 kHz
Directivity Index (DI)	9.6 averaged 1 kHz to 10 kHz
Power Handling	
Average	60 W
Programme	120 W
Peak	240 W
Recommended Amplifier Power	120 W @ 6 ohms
Nominal Impedance (Lo, Z)	6 ohms
Rated maximum SPL (1 m, Lo Z) ⁽³⁾	
Average	105 dB
Peak	111 dB
Crossover Point	4.3 kHz - 2nd order LF, 2nd order HF

Distortion			
10% full power (6.0 V)		Harmonics	
		2nd	3rd
	250 Hz	0.934%	0.316%
	1 kHz	0.292%	0.560%
	10 kHz	0.740%	0.050%
1% full power (1.9 V)			
	250 Hz	0.225%	0.326%
	1 kHz	0.082%	0.363%
	10 kHz	0.147%	0.066%

Transducers	
Low Frequency	160 mm (6.00") mineral loaded cone material
High Frequency	19 mm (0.75")

Physical	
Enclosure	ABS
Grille	Aluminium, Painted
Connectors	Euroblock type removable locking connector with screw terminals with "loop through" facility
Transformer Setting	Rotary switch
Dimensions (H x W x D)	340.5 x 212.2 x 216.5 mm (13.41 x 8.36 x 8.52")
Net Weight (ea)	3.1 kg (6.83 lbs)
Shipped weight	8.5 kg (18.94 lbs)
Supplied Accessories	Yoke bracket
Packed Quantity	2

Transformer Version (specifications as above except)	
Transformer Taps (via front rotary switch)	
70 V	60 W (83 Ω) / 30 W (165 Ω) / 15 W (330 Ω) / 7.5 W (660 Ω) / OFF & low impedance operation
100 V	60 W (165 Ω) / 30 W (330 Ω) / 15 W (660 Ω) / OFF & low impedance operation
Maximum wire gauge for connector	2.5 mm ² CSA (AWG12)
Safety Agency Ratings	UL-1480, CE
Net Weight (ea)	4.1 kg (9.03 lbs)
Shipped Weight	10.6 kg (23.35 lbs)

Ordering Information	
Part Number	Colour
8001 6730 DVS 6	Black
8001 6731 DVS 6	White
8001 6740 DVS 6t	Black
8001 6741 DVS 6t	White



Notes:

1. Average over stated bandwidth. Measured at 1 metre on axis in an Anechoic Chamber
2. Unweighted pink noise input, measured at 1 metre in an Anechoic Chamber

A full range of measurements, performance data, CLF and Ease™ Data for DVS 6 can be downloaded from www.tannoypro.com.

Tannoy operates a policy of continuous research and development. The introduction of new materials or manufacturing methods will always equal or exceed the publishing specifications, which Tannoy reserves the right to alter without prior notice. Please verify the latest specifications when dealing with critical applications.

Copyright (c) 2016 Tannoy Limited. All rights reserved.

7. Technical Specifications

DVS 8/DVS 8t Model

Performance	
System	DVS 6
Frequency response (-3 dB) ⁽¹⁾	75 Hz - 20 kHz
Frequency range (-10 dB) ⁽¹⁾	60 Hz - 30 kHz
Rated sensitivity (1W @ 1m) ⁽²⁾	90 dB
Dispersion (-6 dB)	80 degrees conical
Directivity factor (Q)	12.3 averaged 1 kHz to 10 kHz
Directivity Index (DI)	10.0 averaged 1 kHz to 10 kHz
Power Handling	
Average	70 W
Programme	140 W
Peak	280 W
Recommended Amplifier Power	140 W @ 6 ohms
Nominal Impedance (Lo, Z)	6 ohms
Rated maximum SPL (1 m, Lo Z) ⁽²⁾	
Average	108 dB
Peak	114 dB
Crossover Point	3.4 kHz - 2nd order LF, 2nd order HF

Distortion			
10% full power (6.48 V)		Harmonics	
		2nd	3rd
	250 Hz	0.891%	0.217%
	1 kHz	0.235%	0.643%
	10 kHz	0.666%	0.093%
1% full power (2.05 V)			
	250 Hz	0.236%	0.192%
	1 kHz	0.051%	0.409%
	10 kHz	0.217%	0.081%

Transducers	
Low Frequency	200 mm (8.00") mineral loaded cone material
High Frequency	19 mm (0.75")

Physical	
Enclosure	ABS
Grille	Aluminium, Painted
Connectors	Euroblock type removable locking connector with screw terminals with "loop through" facility
Transformer Setting	Rotary switch
Dimensions (H x W x D)	451.8 x 290.0 x 296.0 mm (17.78 x 11.42 x 11.65")
Net Weight (ea)	5.3 kg (11.67 lbs)
Shipped weight	14.6 kg (32.16 lbs)
Supplied Accessories	Yoke bracket
Packed Quantity	2

Transformer Version (specifications as above except)	
Transformer Taps (via front rotary switch)	
70 V	60 W (83 Ω) / 30 W (165 Ω) / 15 W (330 Ω) / 7.5 W (660 Ω) / OFF & low impedance operation
100 V	60 W (165 Ω) / 30 W (330 Ω) / 15 W (660 Ω) / OFF & low impedance operation
Maximum wire gauge for connector	2.5 mm ² CSA (AWG12)
Safety Agency Ratings	UL-1480, CE
Net Weight (ea)	6.3 kg (13.88 lbs)
Shipped Weight	16.6 kg (36.56 lbs)

Ordering Information	
Part Number	Colour
8001 6750 DVS 8	Black
8001 6751 DVS 8	White
8001 6760 DVS 8t	Black
8001 6761 DVS 8t	White



Notes:

1. Average over stated bandwidth. Measured at 1 metre on axis in an Anechoic Chamber
2. Unweighted pink noise input, measured at 1 metre in an Anechoic Chamber

A full range of measurements, performance data, CLF and Ease™ Data for DVS 8 can be downloaded from www.tannoypro.com.

Tannoy operates a policy of continuous research and development. The introduction of new materials or manufacturing methods will always equal or exceed the publishing specifications, which Tannoy reserves the right to alter without prior notice. Please verify the latest specifications when dealing with critical applications.

Copyright (c) 2016 Tannoy Limited. All rights reserved.

8. Warranty

No maintenance of the DVS Series loudspeaker is necessary.

As part of the MUSIC Group, Tannoy is committed to providing the highest quality products, service and user experience for our customers. One element of this commitment is our after sales support which now incorporates our extended Limited Warranty. In the event of any concern that is not addressed by this extended Limited Warranty we would ask you to contact us at care@music-group.com

For full warranty details including the extended Limited Warranty, please visit <http://www.music-group.com/warranty.aspx> and register your purchase online at www.music-group.com or www.tannoy.com

Notes

tannoypro.com

6481 0584/180216