

Included Components

1. TQ6 x1
2. Remote x1
3. IEC Power Cable x1
4. Quick Start Guide x1



Setup



1 Connect power cable to TQ6, connect other end to a power outlet to charge immediately. Once charged, the TQ6 can be operated on AC or Battery Power.

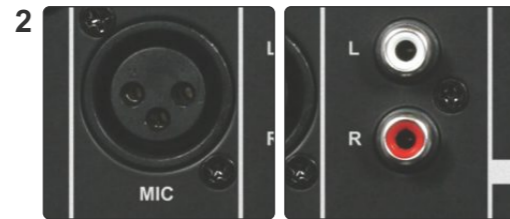

2 Connect your microphone to CH1 with an XLR Cable, or connect a Stereo Line Level source to the CH2 RCA inputs.



3 The 1/4" Line Output can be used to send the TQ6 audio to another sound system or recorder.

Stand Mounting (Optional)



1 Lift the TQ6 over the speaker stand and align the speaker pole with the pole socket on the bottom of the TQ6.



2 Bring the TQ6 down onto the speaker stand gently until it is fully inserted.

Operation



1 Start with the Master Level set about mid-way, and the Tone set mid-way between Treble and Bass. All other level controls should be turned down (counter-clockwise to lower, clockwise to increase).

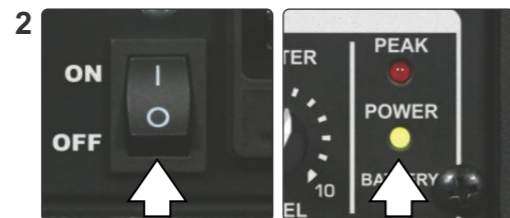

2 Power on the TQ6 by pressing the power switch into the ON position. The Power LED will light up.



3 Level control: Use the Channel Level control to raise your input to the desired level. If needed, the Master Level can be raised.



4 To adjust the Tone, turn the Tone knob clockwise for more Bass, or turn the knob counter-clockwise for more Treble.



5 Raise the Echo Level to add echo to the mic input source.

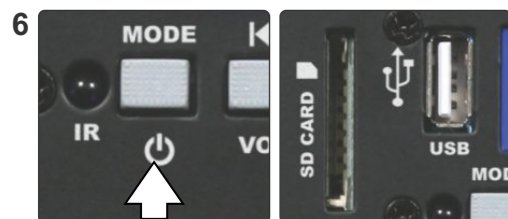

6 MP3 Player Power/Modes: Power on the built-in MP3 player by pressing and holding the Power/Mode button. Press Mode button to switch between SD, USB, and Bluetooth modes.

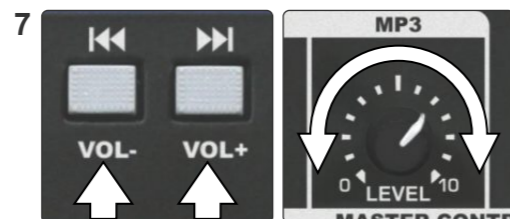

7 MP3 Player Skip/Volume: Skip forward or backward between tracks by pressing the skip buttons. Holding the buttons down will increase or decrease the volume. The level is also controlled by the MP3 Level knob.



8 MP3 Player Repeat: Pressing the Repeat button once will repeat the current track. Pressing a 2nd time will repeat a folder. Pressing a 3rd time will repeat all. Press once more and the repeat function will be turned off.

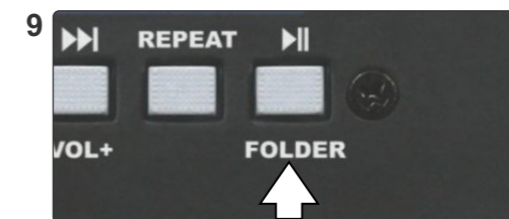

9 MP3 Player Play/Pause/Folder: Pressing Play/Pause will either play or pause the audio. Press and Hold the button for the Folder function. You can switch between folders in an SD or USB device.



10 MP3 Player Bluetooth: In Bluetooth mode, pairing is activated. Make sure your Bluetooth enabled Smart Device is on. Find the TQ6 in the device list, then select it to pair.



Quick Start Guide



FAQ

- 1. Q. What is the Echo for?**
A. To enhance singing for karaoke, etc.
- 2. Q. Can I connect a mixer XLR output to CH1 XLR input?**
A. The XLR input is mic level, a line level mixer output will cause it to distort.
- 3. Q. Can the MP3 player and CH1 mic input be used at the same time?**
A. Yes, all inputs are available simultaneously and levels mixed with individual controls.
- 4. Q. Will the TQ6 run on AC power if the battery is dead?**
A. Yes, and it will charge the battery while in use.
- 5. Q. How often should I plug the TQ6 in to charge?**
A. It is recommended to leave it plugged into AC when ever it is not in use. Always charge after each use. Do not store with battery discharged.



MAKERS OF THE ORIGINAL
HOT SPOT PERSONAL MONITOR

BE HEARD™

Other Helpful Sources

TQ6
Product Page



TQ6
Manual



(PDF Download)

TQ6
Cutsheet



(PDF Download)

TQ6
How To Video



Specifications subject to change without notice.