

PDIC3FR PDIC35 PDIC4
Ceiling / Wall Speakers, Aluminum Frame Speaker Pair

PDICLE3FR PDICLE35 PDICLE4
Ceiling / Wall Speakers, Aluminum Frame Speaker Pair with Built-in LED Light

PDICBTL3F PDICBTL35 PDICBTL4
2-Channel Bluetooth Ceiling / Wall Speakers, Aluminum Frame Speaker Pair with Built-in LED Light

PDIC4CBTL3B PDIC4CBTL35B PDIC4CBTL4B
4-Channel Bluetooth Ceiling / Wall Speaker Kit. (4) Aluminum Frame Speakers with Built-in LED Light

ALUMINUM ALLOY-FRAME SPEAKER
 INSTALLATION MANUAL



Thank you for purchasing this PYLE Aluminum Alloy-Frame speaker system. Bluetooth Wireless Technology, 5W LED Light is a state-of-the-art product carefully designed and manufactured for your installation needs and has been thoroughly tested to ensure consistent and reliable performance. If you have any question about the installation or operation of your PYLE Aluminum Alloy-Frame speaker system, Bluetooth Wireless Technology, 5W LED Light which are not answered by this manual, contact your dealer immediately.

Additional Aluminum Frame Speakers & Options:

Model Number	Amount of Speakers	Speaker Size	MAX Output Power	Aluminum Housing	Built-in Tweeter	LED Light Bulb	Bluetooth Receiver	Aux In	Cut-Out Diameter	Mounting Depth
PDIC3FR	2	3.0"	100 Watt	-	-	-	-	-	3.7"	2.2"
PDICLE3FR	2	3.0"	100 Watt	-	-	-	-	-	3.7"	2.4"
PDICBTL3F	2	3.0"	100 Watt	-	-	-	-	-	3.7"	2.4"
PDIC4CBTL3B	4	3.0"	200 Watt	-	-	-	-	-	3.7"	2.4"
PDIC35	2	3.5"	140 Watt	-	-	-	-	-	4.2"	2.5"
PDICLE35	2	3.5"	140 Watt	-	-	-	-	-	4.2"	2.7"
PDICBTL35	2	3.5"	140 Watt	-	-	-	-	-	4.2"	2.7"
PDIC4CBTL35B	4	3.5"	280 Watt	-	-	-	-	-	4.2"	2.7"
PDIC4	2	4.0"	160 Watt	-	-	-	-	-	4.5"	2.7"
PDICLE4	2	4.0"	160 Watt	-	-	-	-	-	4.5"	3.0"
PDICBTL4	2	4.0"	160 Watt	-	-	-	-	-	4.5"	3.0"
PDIC4CBTL4B	4	4.0"	320 Watt	-	-	-	-	-	4.5"	3.0"



1600-63rd Street
 Brooklyn, NY 11204 USA

PDIC3FR PDIC35 PDIC4
Ceiling / Wall Speakers, Aluminum Frame Speaker Pair

Speaker Wiring

Connect the red cable to the terminal marked with a plus Non the speaker, and the black cable to the terminal marked with a minus symbol (-).
 Picture A, B are speakers and Picture C is Amplifier.

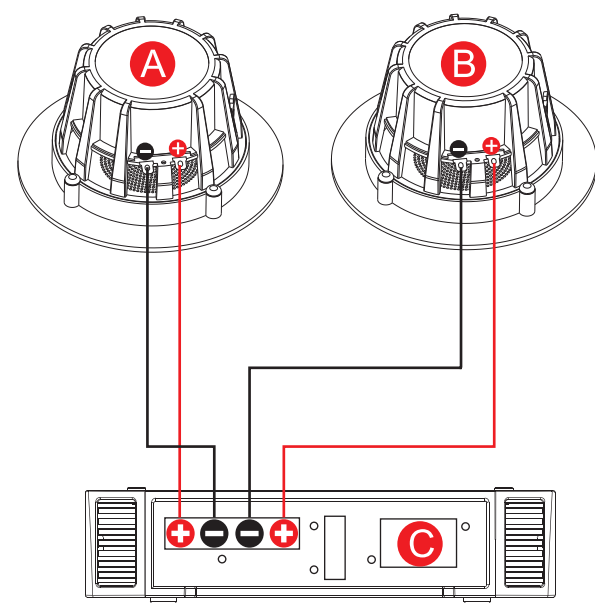

PDICLE3FR PDICLE35 PDICLE4
Ceiling / Wall Speakers, Aluminum Frame Speaker Pair with Built-in LED Light

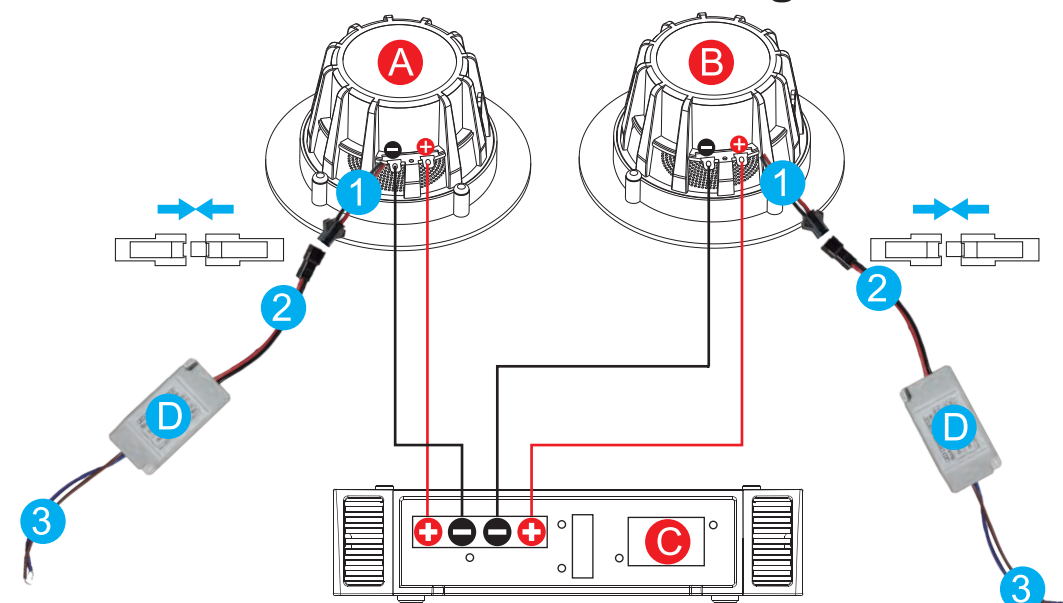

LED Light Wiring
 Picture A, B are speakers, and Picture D is the light Driver. Picture 1 is the light cable on the speaker. Connect Picture 1 to Picture 2 on the light Driver.
 Connect Picture 3 to the power 110V.

PDICBTL3F PDICBTL35 PDICBTL4
2-Channel Bluetooth Ceiling / Wall Speakers, Aluminum Frame Speaker Pair with Built-in LED Light

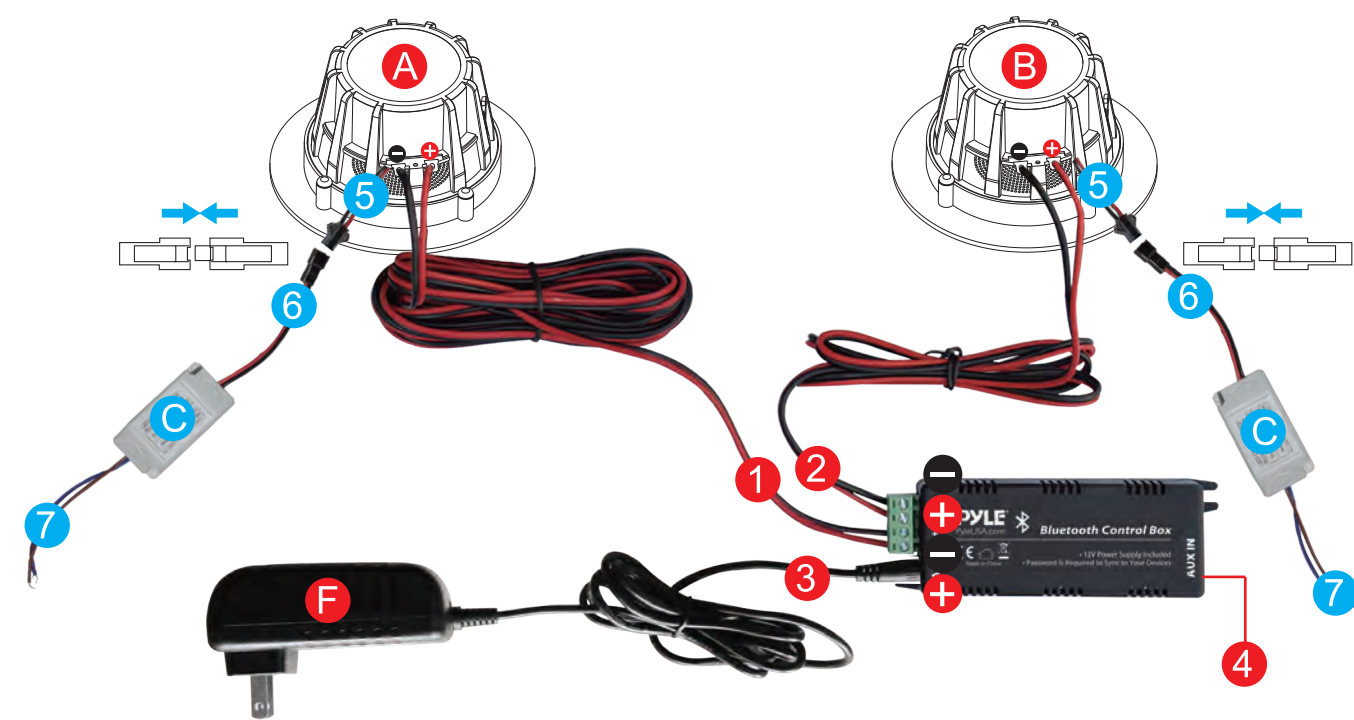

- Bluetooth Version:4.0
- Bluetooth Network Name:Pyle
- Bluetooth Network Password:'0000'
- Bluetooth Wireless Range:30'+Feet

Bluetooth Wiring

Connect the red cable to the terminal marked with a plus Non the speaker, and the black cable to the terminal marked with a minus symbol (-).
 Picture A, B are speakers, and Picture E is Bluetooth controller. Picture 2 are cables.
 Cable 1 connects to speaker A, Cable 2 connects to speaker B.
 Picture F is Power Supply, Insert picture 3 to the power port(DC12V) of the bluetooth.
 Picture 4 is Aux in port.

LED Light Wiring

Picture A, B are speakers, and Picture C is the light Driver. Picture 5 is the light cable on the speaker. Connect Picture 5 to Picture 6 on the light Driver.
 Connect Picture 7 to the power 110V.

PDIC4CBTL3B PDIC4CBTL35B PDIC4CBTL413
4-Channel Bluetooth Ceiling / Wall Speaker Kit, (4) Aluminum Frame Speakers with Built-in LED Light

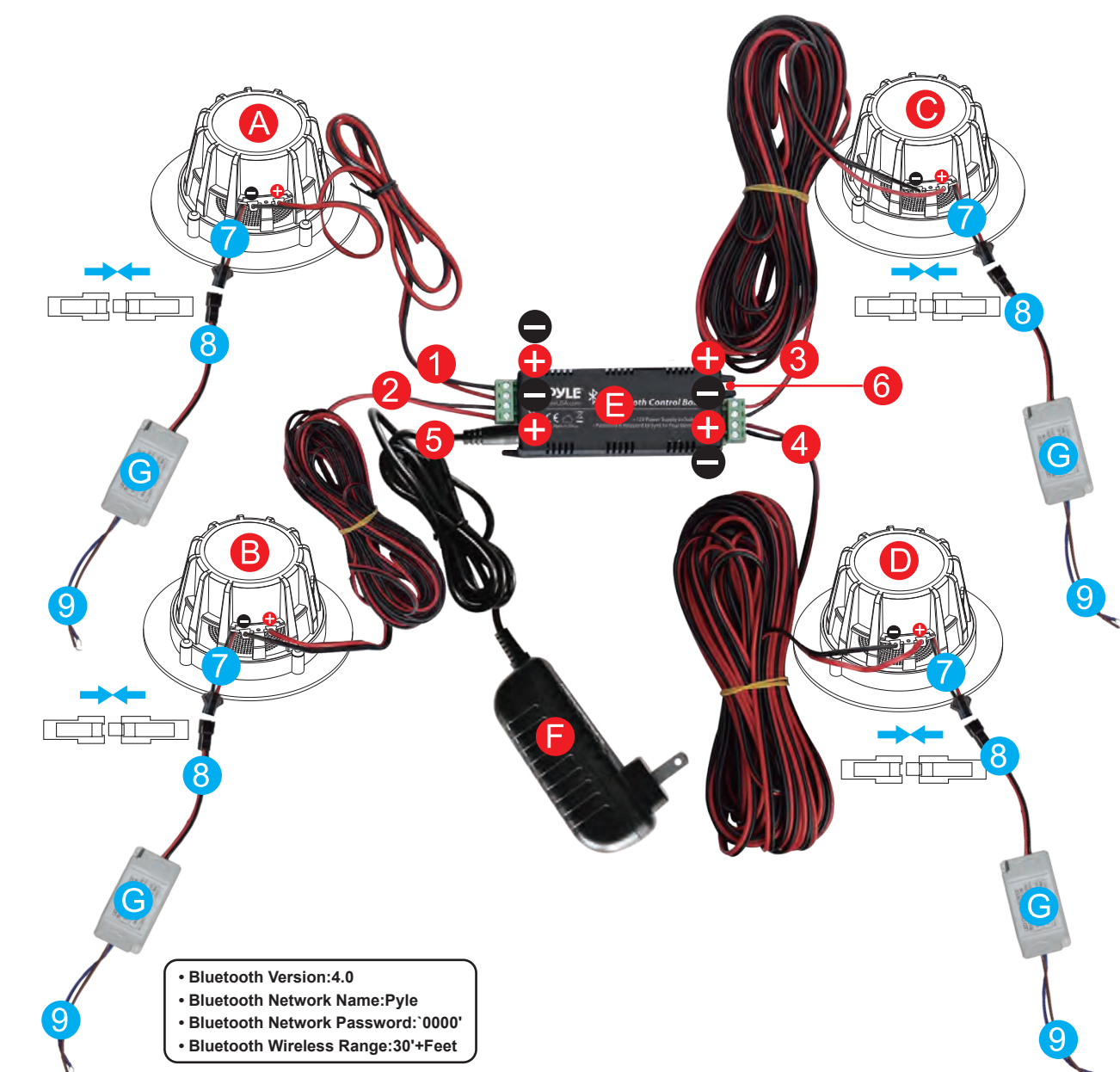

- Bluetooth Version:4.0
- Bluetooth Network Name:Pyle
- Bluetooth Network Password:'0000'
- Bluetooth Wireless Range:30'+Feet

Bluetooth Wiring

Connect the red cable to the terminal marked with a plus (+) on the speaker, and the black cable to the terminal marked with a minus symbol (-).
 Picture A, B, C, D are speakers and Picture E is Bluetooth controller. Picture 1, 2, 3, 4 are cables.
 Cable 1 connects to speaker A, Cable 2 connects to speaker B, Cable 3 connects to speaker C, Cable 4 connects to speaker D.
 Picture F is Power Supply, Insert picture 5 to the power port(DC12V) of the bluetooth.
 Picture 6 is Aux in port.

LED Light Wiring

Picture A, B, C, D are speakers, and Picture G is the light Driver. Picture 7 is the light cable on the speaker. Connect Picture 7 to Picture 8 on the light Driver.
 Connect Picture 9 to the power 110V.