



# RF31-EZ-T

Install Instructions For:  
RF31-EZ-T speaker

## Box contents

- 1 Speaker
- 1 Grille
- 1 Paint mask
- 4 Mounting screws

## Optional Accessories

- Theft-resistant, stainless steel grille (AC-RF31-TRG)

**NOTE:** the RF31-EZ-T is designed to install into a standard 2-gang junction box. SoundTube recommends you test the fit before installing the junction box.

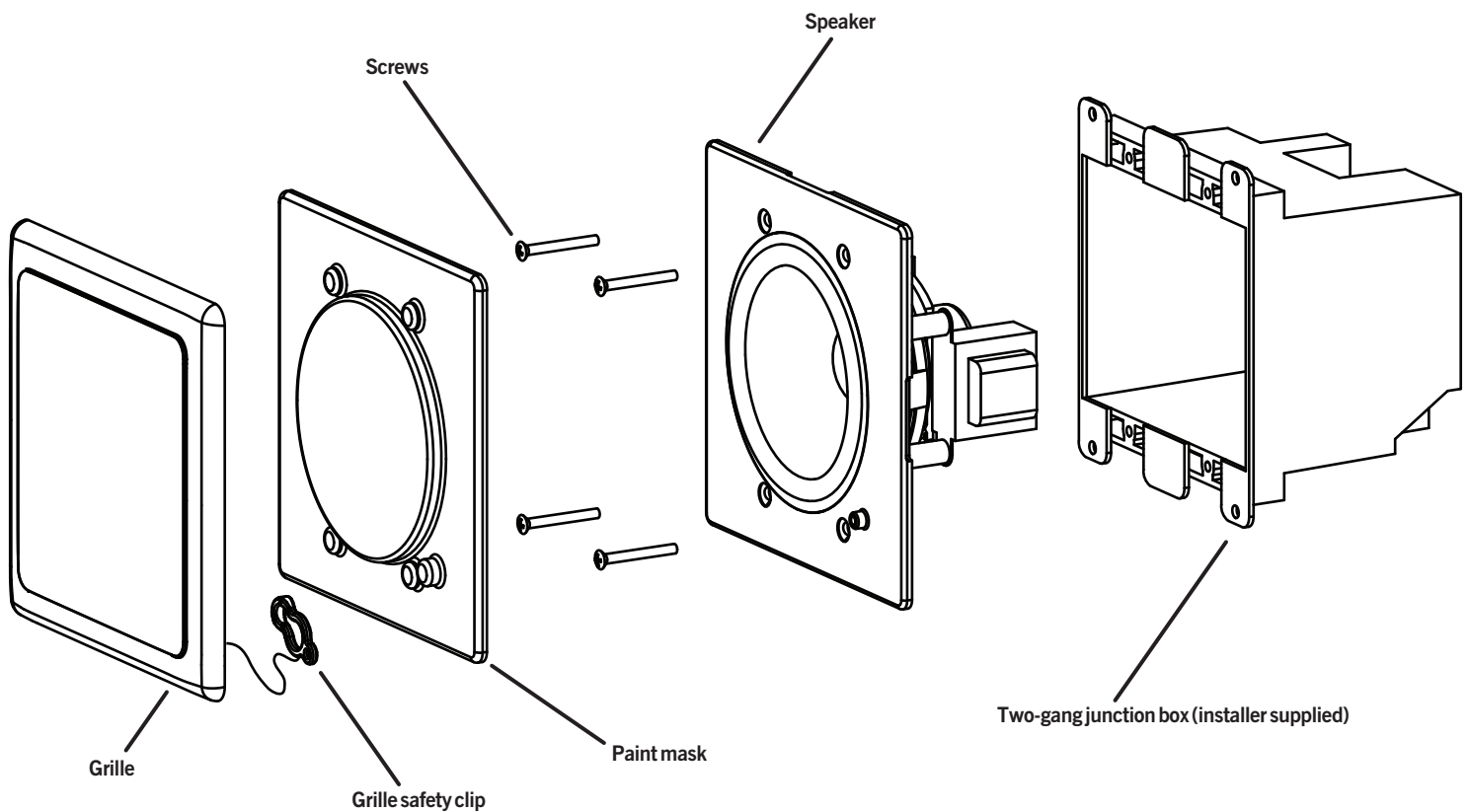

### Warning

SoundTube speakers must be installed by a professional audio installer/contractor. For safety and for optimum audio performance, installer must follow all directions issued by SoundTube Entertainment.

### Warning

Do not spec or install speaker near support beam, ventilation duct or other structure that may interfere with speaker function or dispersion.

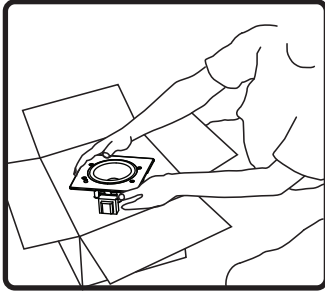

**1.** Unpack speaker.

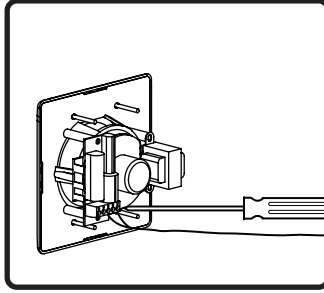

**2.** Connect signal wires to speaker using terminal block. Connect - wire to "C". Connect + wire according to step 2a.

Terminal	100v	70.7v	25v
	C	Ground	Ground
1	X	10w	1.3w
2	10w	5w	0.7w
3	5w	2.5w	0.4w
4	2.5w	1.3w	0.2w

**2a.** Terminal Settings

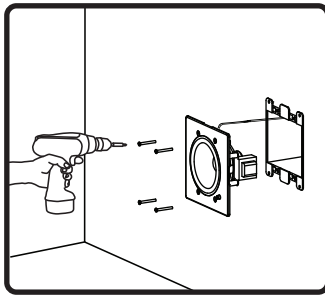

**3.** Install the RF31-EZ into the installer-supplied junction box using included fasteners. Note: for best performance, make sure that junction box is well sealed.

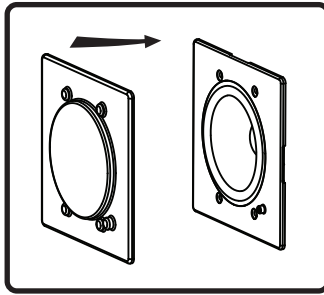

**4.** If space isn't yet finished, apply paint mask to protect RF31. Remove when finish work is complete.

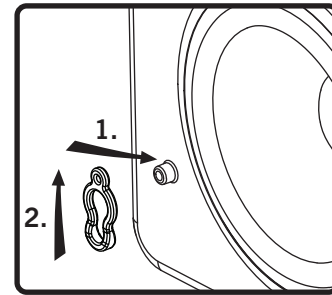

**5.** Attach grille safety clip by placing the large end of the clip over snap-fit post (1), then sliding clip until small end snaps into place around post (2).

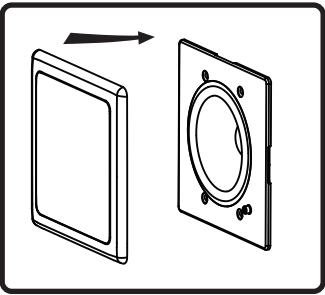

**6.** Align tabs on snap-fit grille with slots in baffle, gently press grille into place.

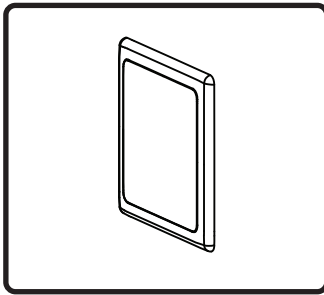

**7.** Done!