

Rockustics®

ULTRA-FIDELITY OUTDOOR SPEAKERS



XT-SURROUNDSTONE | OWNER'S MANUAL

XT-SURROUNDSTONE | OWNER'S MANUAL

Please read the following instructions carefully before installing your Rockustics® Rock speaker. If you have any questions regarding installation that are not answered in the following directions, please contact your local sound contractor or the Rockustics®/MSE Audio® technical support team. Contact information can be found on the back of the manual.

Basic Wiring

(Diagram A) Locate speaker wire on the underside of the rock. If necessary, strip the wire ends and trim the wire to the appropriate length. Use the supplied silicone wire nut to connect the positive (red) leads of the speaker and input wires. Repeat this step with the negative (black) leads. Rockustics recommends using 14ga or heavier Direct Burial cable for the connection between the amplifier and the speakers.

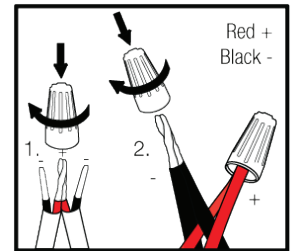

Diagram A

NOTE: The provided wire nuts are meant for permanent installation use only. If you are temporarily wiring the speakers, do not use these wire nuts. In the event you have used the wire nuts, and need to re-wire your system, do not attempt to unscrew the nuts. Instead, clip the wires below the nut, and follow the steps in the [Basic Wiring](#) section with a new pair of waterproof wire nuts (these are available at most hardware stores).

Optimizing Speaker Placement for Best Sound

All Rockustics speakers can generate a high SPL (sound pressure level). Be ready to rock, but be considerate of your neighbors! Maximum acoustic performance should be an important factor in determining speaker placement. Here is how to achieve it:

- 1) Establish where the most likely or average listening position will be.
- 2) The speakers should be placed at or close to the same distance from that point.
- 3) The actual distance between the listening position and the location of the speakers is not critical. However, keep in mind that as the distance between listening area and speaker is increased, there will be a noticeable decrease in perceived volume.
- 4) Be sure to confirm amp power matches the power rating on the speaker. Over-driving the speaker can lead to permanent damage that is not covered under warranty.

Optimizing Aesthetics with Speaker Placement

All Rockustics products are designed with a boost in high frequency response to accommodate for placement near plants and other landscaping features. Feel free to position the product within your landscaping, camouflaged near bushes or shrubs. Rockustics products strive to blend into the natural aesthetic of their surroundings.

Be sure to account for the wires which will run from the rock to your stereo or audio source. Camouflage wires by running them an inch below ground level when possible.

Cautions and Maintenance

All Rockustics Rock Series speakers are sealed and fully weatherproof. However, DO NOT place speakers where the grille will be in the path of a sprinkler system. Sprinklers typically have a high water pressure level that can damage speaker cones if hit directly.

DO NOT place soil or wood chips over the speaker grille. If the grilles accumulate a build up of soil, the speaker may become damaged. If build up does occur, simply rinse the grille with a garden hose set to a low pressure level. Accumulated soil may also promote undesired insect traffic into the speaker. Insects may eat through the speaker cone. Chemical sprays may also cause damage to the rubber of the speaker surround. This includes bug spray, deck sealant, some fertilizers and oil based products. Speakers MUST be covered when applying these treatments or chemicals in your yard.

For environments that get snow and ice during the winter months, be sure to check that the openings and woofer cone are clear and there is no hard-packed snow or ice built up in these areas before playing. If there is ice or snow present on the cone, use a hair dryer set on a low setting to melt it away. If the speakers are not going to be used during winter months, it is recommended that they either be disconnected and brought indoors, or covered with a plastic bag to help protect the speaker components.

Setup

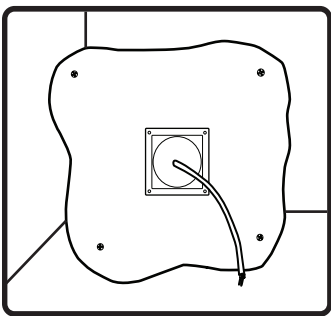

1. Locating Wire

Locate speaker wire on the underside of the speaker. Strip wire ends if necessary.

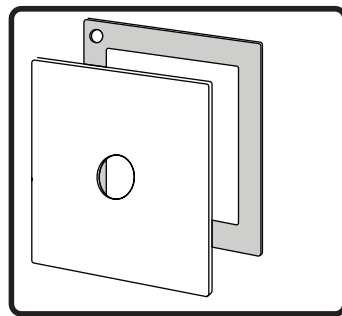

2. Gasket

Attach the gasket to the smooth side of the bottom cover plate.

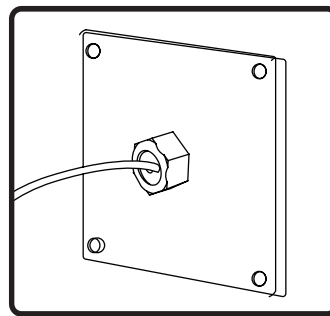

3. Attaching Gland

Attach the supplied liquid-tight strain relief gland to the cover plate and thread signal wires through the gland.

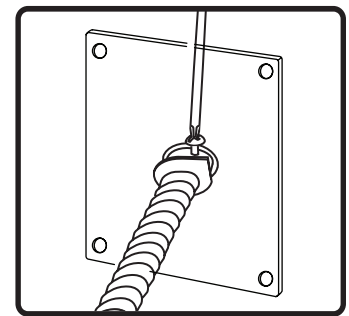

4. Conduit

Attach the conduit clamp to the cover plate. It may be necessary to increase the opening in the cover plate to fit the conduit connector. Thread signal wires through the conduit clamp and affix the conduit clamp.

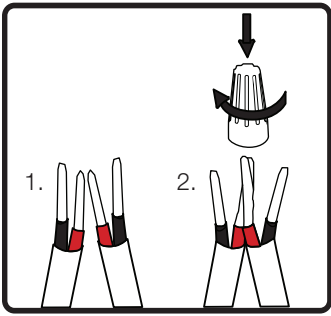

5. Connecting Wire

Connect the speaker wire to the input signal wire. Red is positive, black is negative. Use included wire nuts to secure the connection. Tuck wires and wire nuts into the pocket on the underside of the speaker.

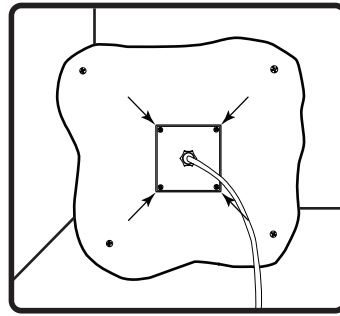

6. Cover Plate

Place cover plate over the pocket on the underside of the speaker and secure with the 4 supplied screws. This process will be the same if you are using the conduit.

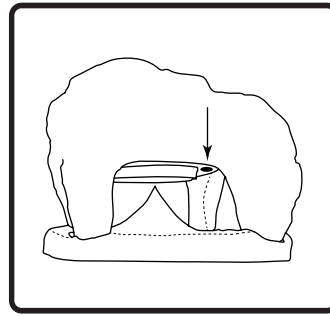

7. Tap Settings

To change tap settings, remove the plug located next to the driver to uncover the tap switch. Use a small flat head screwdriver to adjust the switch for the desired setting. The tap switch is a six-position rotary switch with positions for 64 W, 32 W, 16 W, 8 W, 4 W, and transformer bypass (8 Ω). The tap switch will be set to the highest 70.7 volt setting from the factory (64 W).

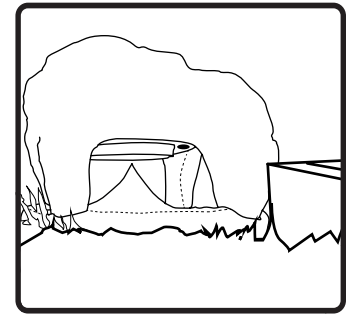

8. Done