



XT Series | Install Instructions For:
XT850-LED

1.435.647.9555 | 800.647.TUBE | www.soundtube.com

Box contents

- 1 In-ground speaker
- 1 Anti-theft device (2 pieces)
- 1 Liquid-tight compression fitting
- 1 Square drive bit
- 4 Wire nuts
- 6 #8 stainless-steel square-drive screws
- 2 .75" 1/4-20 Stainless-steel bolts

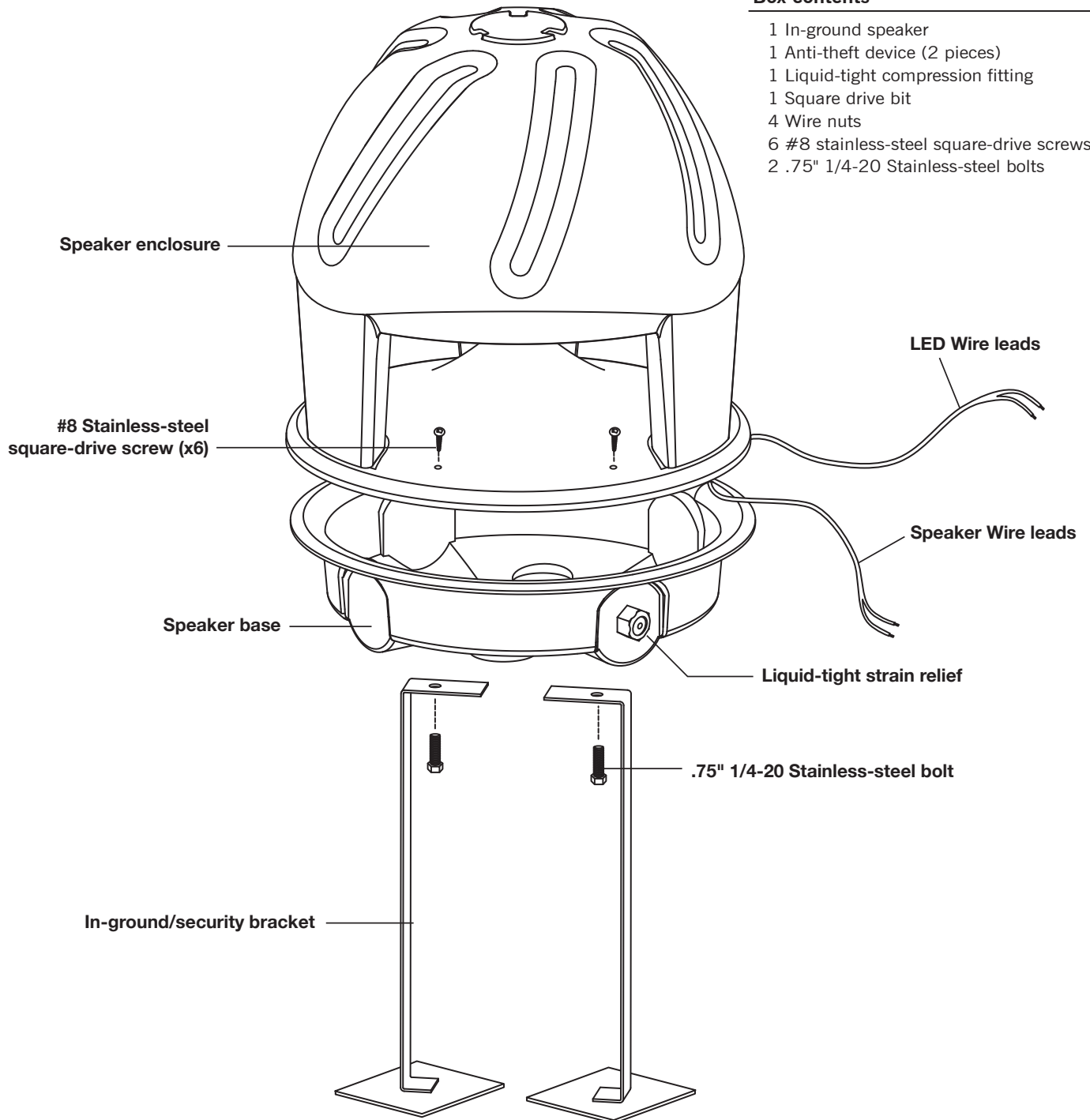

Transformer Tap Settings

	Voice Coil	70.7 Volt Transformer Taps (dB)	100 Volt Transformer Taps (dB)	25 Volt Transformer Taps (dB)
XT550	4 Ohm=107 dB	32W=103, 16W=100, 8W=97, 4W=94	32W=103, 16W=100, 8W=97	4W=94, 2W=91, 1W=88, .5W=85
XT850	4 Ohm=110 dB	64W=108, 32W=105, 16W=102, 8W=99	64W=108, 32W=105, 16W=102	8W=99, 4W=96, 2W=93, 1W=90

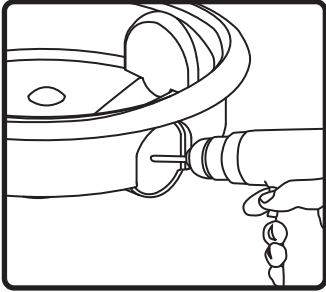

1. If needed for daisy chaining drill speaker base and install second liquid-tight strain relief (not included).

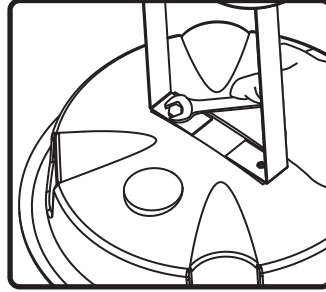

2. Attach inground/security brackets to speaker base using stainless-steel bolts.

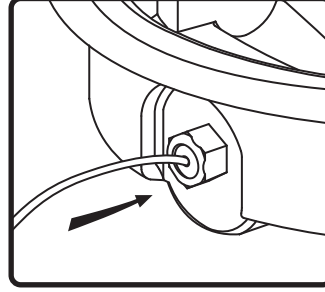

3. Thread signal wire thru liquid-tight strain relief and tighten seal.

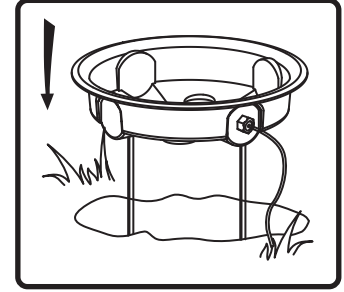

4. Place speaker base into hole in ground with the top rim of the base at ground level. Back-fill dirt in to hole, packing the dirt firmly. For added security, cement security brackets into ground.

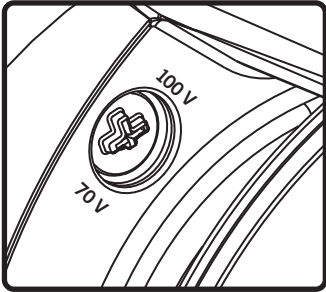

5. Select the tap position by removing the rubber plug to access rotary switch. Switch is preset to maximum tap setting in 70.7 V mode (64W XT850, 32W XT550). Select desired setting and reinsert rubber plug.

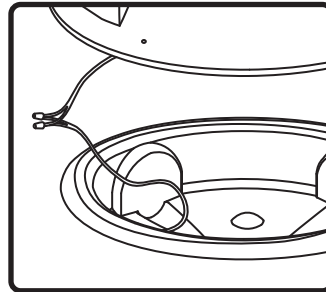

6. Attach signal wire to wire leads. Use wire nuts provided. For added water proofing, grease caps are recommended.

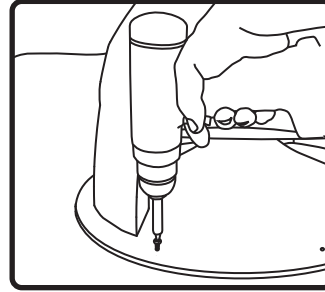

7. Set speaker enclosure on speaker base. Use tamper-resistant stainless-steel screws to attach speaker to base (driver tip and screws provided).

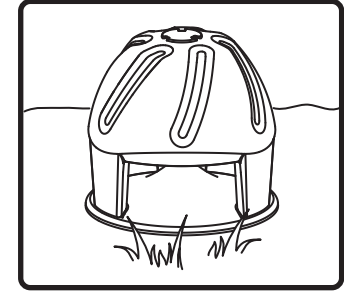

8. Done!

Port option for XT550

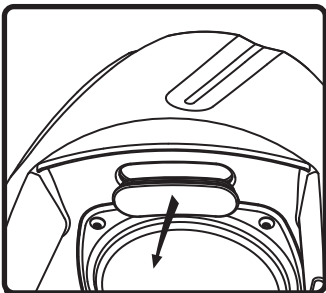

To enhance bass performance, remove port cover on the underside of speaker enclosure.
Warning: Removing the cover will expose internal components to humidity and other potentially corrosive elements.

LED Wiring for XT850-LED

1. Consult transformer manufacturer's installation and connection instructions first. Unravel LED wire pair. Connect XT850-LED wires to appropriate landscape lighting cable and landscape lighting transformer. Black/White wire is Positive, all-Black wire is Negative.

2. Each XT850-LED lighting system is rated at 12 V / 3.6 W. It is recommended not to exceed 80% of the transformer's power rating. For example, a 30 Watt transformer can accommodate up to (6) XT850-LED speakers.

Transformer Power Capacity	Max. # of XT850-LED
30 W	6
60 W	12
150 W	34
300 W	68

*LEDs can operate at 9 V and will yield approximately 35% brightness. XT850-LED's are also compatible with third-party dimmer switches.

Warning

SoundTube speakers must be installed by a professional audio installer/contractor. For safety and for optimum audio performance, installer must follow all directions issued by SoundTube Entertainment.