

BACK BOX

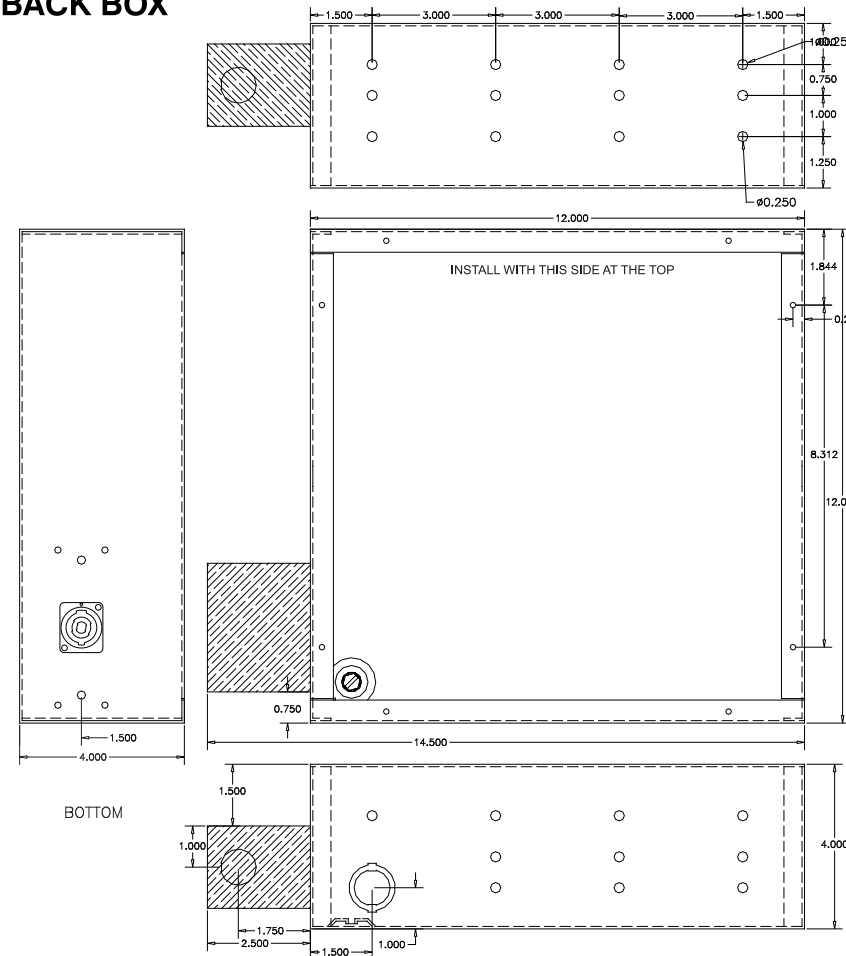

MOUNTING INSTRUCTIONS

The Presspower WP is designed to fit between standard 16" stud centers. The backbox must be securely mounted to support the weight of the unit with the cover attached. Attach the right side of the backbox to the adjacent wall stud with a minimum of 8 #12x1" self drilling screws. It is recommended that a horizontal support be installed at the bottom of the enclosure. Allow for access to the cable entry knockouts through the cross member. A second horizontal cross member can be installed across the top of the backbox for additional support. Use additional #12x1" self drilling screws through the top of the backbox into the upper support.

BLOCK DIAGRAM

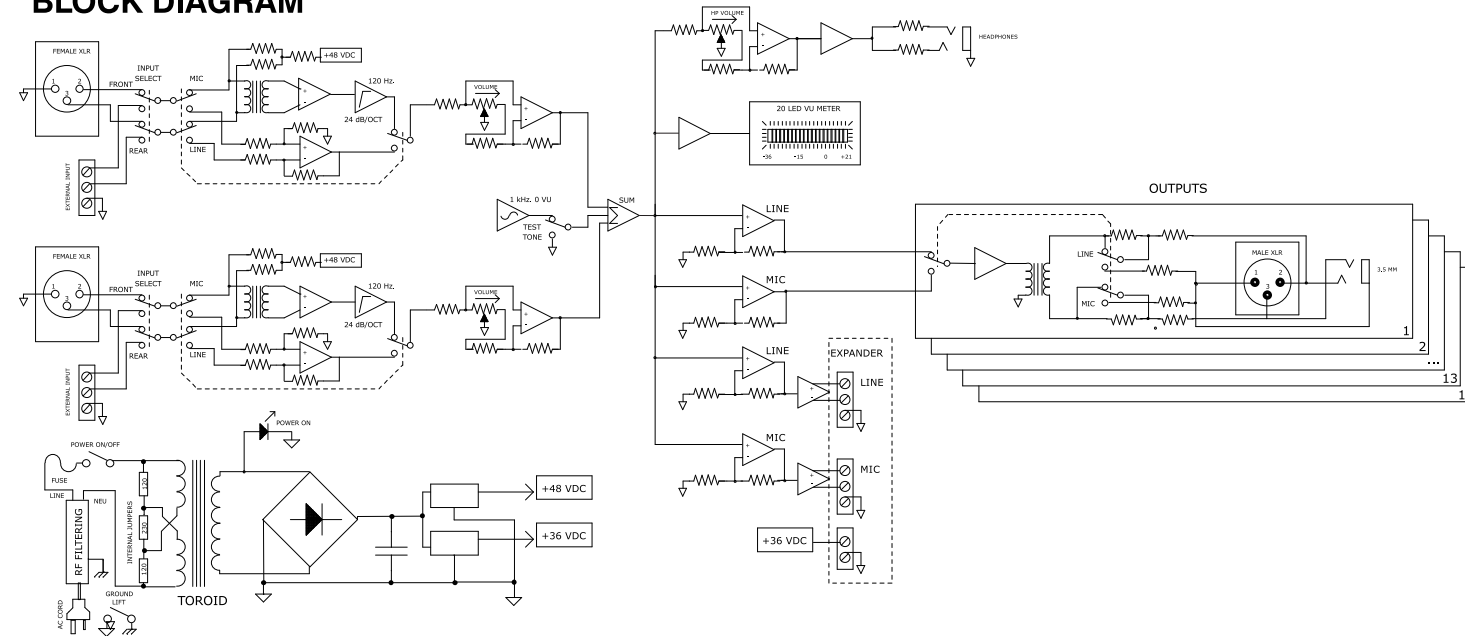

Whirlwind
 99 Ling Road
 Rochester, NY 14612
 Phone 800 733-9473 . Fax 585 865-8930
 Email: Sales@whirlwindusa.com
 http://whirlwindusa.com
MADE IN USA

WARRANTY: This product is guaranteed to be free from defects in materials and workmanship to the original purchaser for a period of 5 years from the date of purchase. Should service be required, return the unit postage prepaid along with the original sales receipt to:

whirlwind
 Attention - Repair
 99 Ling Road
 Rochester, New York 14612

The warranty on this product shall not apply to defects or damage resulting from abuse, abnormal use or from repairs or modifications performed by anyone other than whirlwind. If it is determined a manufacturing defect has occurred, whirlwind will repair or replace the unit at our option and pay the postage back to you.

whirlwind

PressPower WP

INTRODUCTION

Thank you for selecting the Whirlwind Presspower WP audio press feed distribution box. The Presspower WP is a permanent wall mount unit that delivers broadcast quality audio from 14 mic or line level transformer isolated outputs. Features include a 20 segment LED VU display for quick visual level setting, a headphone monitoring section, a tone oscillator for level calibration and a locking cover. There are two balanced input channels, switchable to accept mic or line level signals. Audio can be applied to either the front panel jacks or to optional, remotely located connectors (see installation). Each input channel has a switch to select the desired input connector. Connections are available for an optional expander unit, the PRESS2XP, which provides 16 additional mic or line level outputs. Wiring for the expander and the remote inputs must be done at the time of installation. There are two versions of the Presspower WP: model PRESS WALL, which requires 110 VAC 60 HZ power and model PRESS WALLX that requires 220VAC 50/60 Hz. A single gang conduit box that accepts 1/2" conduit fittings is provided for connection to building power. Consult local building codes for proper installation.

FEATURES

The Whirlwind Presspower WP is a permanent installation version of the industry standard Presspower 2. All the same features are included in this package:

- 14 mic or line level outputs
- XLR or 3.5mm transformer balanced output jacks
- Complete ground isolation between outputs
- 2 mic or line level inputs
- Choose front panel inputs or remote connections
- Expander connection for additional outputs
- Test tone for level calibration
- Headphone monitoring of input signals
- Installs between 16" wall stud centers

UNPACKING

Whirlwind has made every effort to ensure that your equipment is received in the same perfect condition it was in when it left the factory. Please inspect your product for any signs of damage during shipping and report them to your dealer so that a claim can be presented to the shipper. We recommend that you save your packaging material for use in the unlikely event that you need to return your equipment for service. The electronic unit can be removed from the wall box for service without disturbing the power connection.

INSTALLATION

The Presspower WP is designed to fit between standard 16" stud centers. The included backbox must be securely mounted to support the weight of the unit with the cover attached. The right side of the backbox should be firmly secured to the adjacent wall stud with a minimum of 8 #12x1" self drilling screws. It is recommended that a horizontal support be installed at the bottom of the enclosure. Allow for access to the cable entry knockouts through the cross member. A second horizontal cross member can be installed across the top of the backbox for additional support. Use additional #12x1" self drilling screws through the top of the backbox into the upper support.

Power requirements are standard US 110 VAC 60 Hz power for the model PRESS WALL and 220 VAC 50/60 Hz for the model PRESS WALLX. A Neutrik® Powercon connector delivers AC to the unit. Connections to the Powercon outlet are made with wire nuts or butt splices inside the single gang conduit box, with 1/2" knockouts, located on the left side of the backbox. There are color coded 12 AWG leads on the Powercon for connection to the incoming building wiring. Black is the line connection, white is the neutral connection and green/yellow is earth. Grounding screws are provided in the AC junction box and also in the backbox. Consult local building codes for proper installation.

Audio wiring for remote inputs and expander unit connections pass through a 1/2 - 3/4" conduit knockout in bottom left of the backbox. Shielded 22 AWG wire: Belden® 1266A, West Penn® 291 or equivalent is recommended as a minimum wire gauge. Three pin 3.5mm pluggable screw connectors attach the audio wiring to the unit. The remote inputs are standard balanced audio: plus, minus, and ground. A two pin 3.5mm plug is used for expander 36 VDC power. The expander wiring should terminate in a female Switchcraft® D6F or equivalent. The pinout is as follows:

- Pin 1 = Power negative and both audio grounds
- Pin 2 = Mic level audio minus
- Pin 3 = Mic level audio plus
- Pin 4 = Line level audio plus
- Pin 5 = line level audio minus
- Pin 6 = Power positive

The cover can be installed to open either left or right by changing the position of the lock strike and the magnetic strips. Upon final installation, remove the adhesive backing from the magnetic strips and attach them above and below the lock body on the inside edge of the door.



CONTROLS AND CONNECTIONS

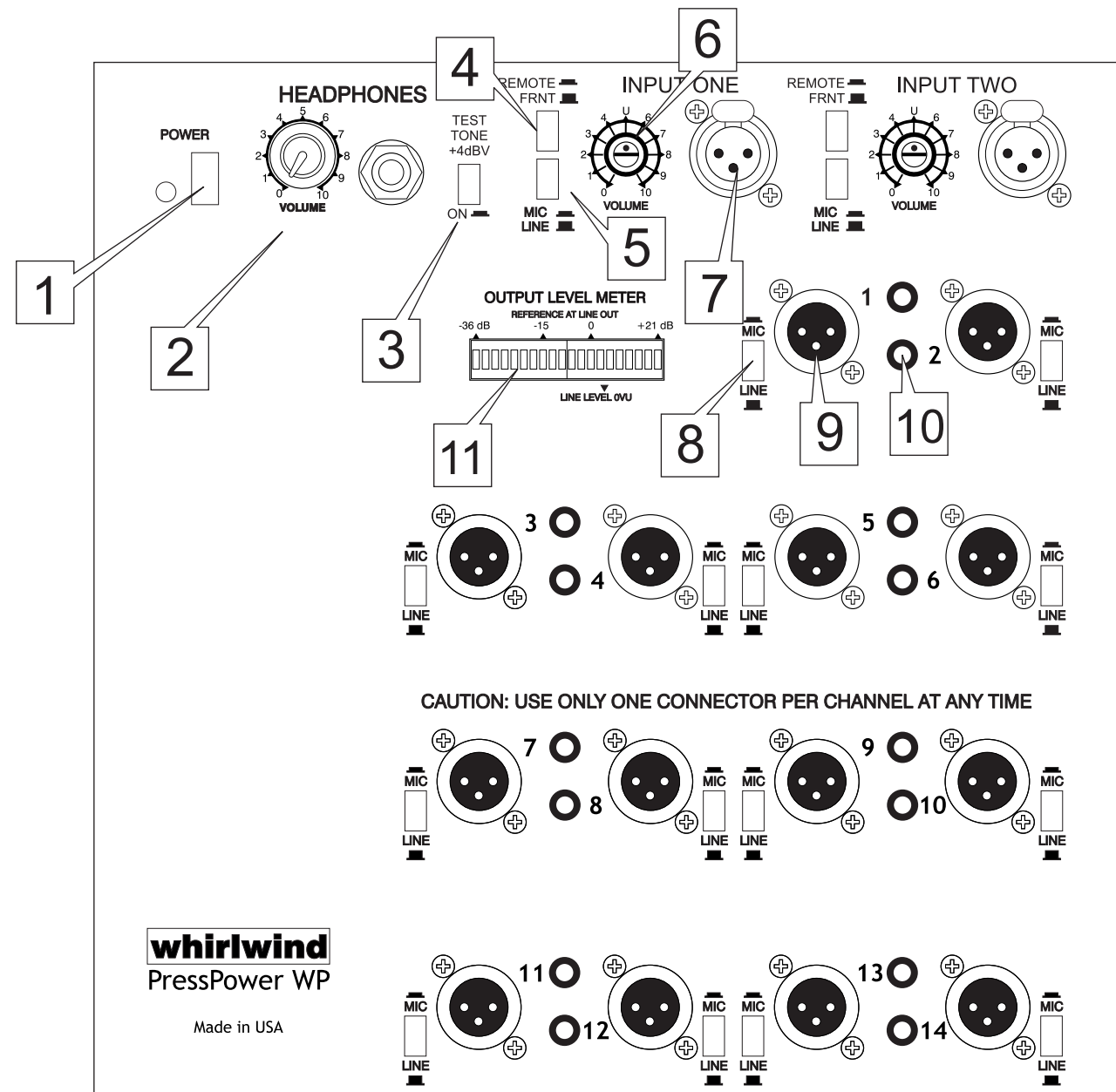

LABEL ON REAR OF UNIT

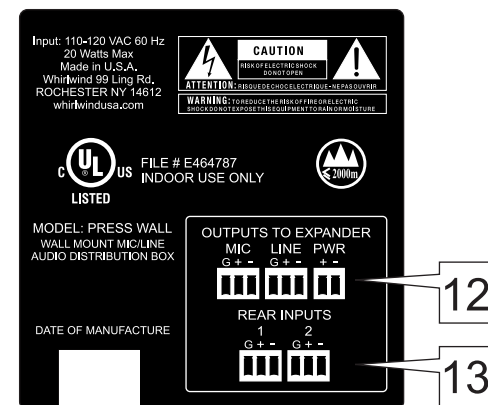

These terminals are located behind the front panel and should be connected at the time of installation, if required.

1 POWER SWITCH applies AC voltage to the unit and illuminates the power LED.

2 HEADPHONE LEVEL CONTROL adjusts the volume at the 1/4" TRS headphone jack through a range of -60 to +20 dBm. The headphone jack works with stereo headphones and with mono earpieces.

3 TEST TONE SWITCH applies a 1 kHz sine wave to all outputs for level calibration during setup. The tone level is +4 dBm or 0 VU in line mode and -43 dBm in mic mode.

4 FRONT/REAR INPUT SWITCH determines the source of the audio signal that is sent to the outputs.

5 INPUT MIC/LINE SWITCH selects the appropriate circuit for the applied signal. The mic circuit is transformer balanced with a maximum input level of -5 dBm. The line circuit is actively balanced with a maximum input level of +35 dBm. The MIC position applies 48 VDC phantom power to the input and activates a low cut filter with a 24 dBm per octave slope, down 3 dBm at 120 Hz. This filter reduces low frequency handling and wind noise. These features are not available in LINE mode.

6 INPUT LEVEL CONTROL varies the amount of signal delivered to the outputs. The 12 o'clock (U) position yields unity gain in either mic or line mode with approximately 6 dB of gain adjustment 90 degrees in either direction. Large increments of adjustment occur at both ends of pot rotation with a total range of -60 to +20 dBm.

7 INPUT XLR female connector is RF filtered with pin 2 positive.

8 OUTPUT MIC/LINE SWITCH selects the signal level at each output. Mic level is 43 dBm below line level.

9 OUTPUT XLR male connectors are transformer isolated and ground lifted from each other, pin 2 is positive.

10 OUTPUT 3.5 MM JACK is wired positive signal to tip and negative to ring. Do not use this and the XLR output simultaneously.

11 20 SEGMENT LED METER with 3 dB per segment resolution provides a wide range display with 1 dB accuracy.

12 OUTPUT EXPANDER TERMINALS for connection of the PRESS2XP 16 channel expander module are located in the recessed compartment inside. Three pin 3.5mm pluggable screw connectors for mic and line audio and a two pin for power are provided with the unit.

13 REMOTE INPUT TERMINALS are also located in the recessed compartment. Three pin 3.5mm pluggable screw connectors are provided with the unit.

AC POWER CONNECTION is a Neutrik® Powercon type. The chassis connector is provided with 12 AWG tails 6" long for termination to the incoming building wiring. Wire nuts or splices to be provided by the installer. Black is the line connection, white is the neutral connection and green/yellow is earth. Grounding screws are provided in the AC junction box and also in the backbox. Consult local building codes for proper installation.

SPECIFICATIONS

Frequency Response Mic mode (Low Cut) Line mode	+/- 3 dB 120 - 20 kHz	Range of Headphone Volume Control	-60 to +20 dBV
	+/- 2 dB 20 - 20 kHz	Isolation between Mic Outputs	120 dB
Input Impedance Mic mode Line mode	1.2 kOhms	VU LED Range	-36 to +21 dBV in 3 dB increments
	>20 kOhms	Phantom Power(mic mode only)	48 VDC
Maximum Input Level Mic mode Line mode	-20 dBV	Power Requirements 120 VAC .16 A 60 Hz	20 Watts maximum
	>20 dBV	Size (with flush cover installed) Backbox with conduit box attached Finished wall opening	14.25 X 14.25 inches 12 H X 14.5 W X 4 D inches 12.25 X 12.25 inches
Output Impedance Mic mode Line mode	100 Ohms	Weight At final installation Shipping	24 lbs 30 lbs
	200 Ohms		
Maximum Output Level Mic mode Line mode	-11 dBV		
	+20 dBV		
T.H.D.+n	.02% at 1 kHz		
Mic Mode Output Level	-43 dB below line		
Equivalent Input Noise	122 dBV		
Range of Level Pot	-60 to +20 dBV		
CMR of Mic Input at 1 kHz	107 dB		
Minimum Headphone Impedance	16 Ohms		

whirlwind