

# DesignMax DM10S-SUB

## surface-mounted subwoofer

### Product Overview

DesignMax loudspeakers bring outstanding audio and aesthetics to any commercial space. The 250-watt DM10S-SUB subwoofer features a 10-inch woofer and delivers a 35 Hz - 125 Hz frequency range. The DM10S-SUB is surface-mounted and locks onto a hidden QuickHold U-bracket. With both black and white versions available, the DM10S-SUB is easy to integrate with any décor.



### Key Features

**Deliver instantly impressive sound** with custom Bose drivers — no DSP or EQ required. For even better sound, use select Bose DSPs and amplifiers to enable Bose loudspeaker EQ

**Blend into any room design** with elegant form factors, minimum-bezel grilles available in black or white, and removable logos

**Reduce installation time** with the patented QuickHold mounting system, which also reduces strain, hassle, and the chance of product damage

**Install easily** — includes Euroblock connectors; deliver high SPL for demanding applications

### Technical Specifications

SINGLE LOUDSPEAKER PERFORMANCE		
Frequency Response (-3 dB) <sup>(1)</sup>	41 - 108 Hz	
Frequency Range (-10 dB) <sup>(1)</sup>	35 - 125 Hz	
Nominal Coverage (H x V)	Omnidirectional below 200 Hz	
Nominal Coverage Angle (1 - 10 kHz)	Omnidirectional below 200 Hz	
	Bose extended-lifecycle test <sup>(4)</sup>	AES component test <sup>(5)</sup>
Power Handling, long-term continuous	250 W	300 W
Power Handling, peak	1000 W	1200 W
Sensitivity (SPL/ 1W @ 1 m) <sup>(2)</sup>	90 dB	90 dB
Calculated Maximum SPL @ 1 m <sup>(3)</sup>	114 dB	115 dB
Calculated Maximum SPL @ 1 m, peak	120 dB	121 dB
Recommended Crossover	80 - 200 Hz (requires active crossover in DSP)	
Recommended High-Pass Protection	40 Hz with recommended 18 dB / octave filter	
Overload protection	Resistor-network power reduction with automatic reset	
Transformer taps	70V: 20, 40, 80, 150 W, bypass 100V: 40, 80, 150 W, bypass	
TRANSDUCERS		
Low Frequency	1 x 10-inch woofer (254 mm)	
Nominal Impedance	8 ohms (transformer bypass)	

# DesignMax DM10S-SUB

## surface-mounted subwoofer

<b>PHYSICAL</b>	
Enclosure Material	High-density wood composite with solid color laminate, UV fade resistant
Grille	Perforated steel, powder-coated finish, paintable, tamper-resistant design
Logo	Rotatable, removable
Color	Black: RAL 9005, White: Bose Arctic White, similar to RAL 9003, Paintable
Environmental / Ingress-Protection	Indoor only
Safety Agency	UL-1480A, S5591/ UL Listed, NFPA70, in accordance with IEC60268-5, ROHS, CE compliant
Operating Temperature Range	0 °C to 50 °C (32 °F to 122 °F)
Connectors	Euroblock 6-pin connector with loop-through, mounted on rear. Accepts 18 AWG (0.8 mm <sup>2</sup> ) to 14 AWG (2.5 mm <sup>2</sup> ) size wire
Suspension / Mounting	QuickHold Mounting System with included U-Bracket
	2 repeatable mounting angles: 0°, 90° for wall or ceiling placement
	One (1) rear M8 screw insert for safety-tether attachment
Dimensions (H × W × D)	502 × 316 × 323 mm (19.8 × 12.5 × 12.7 in)
Dimensions (H × W × D) with bracket	502 × 316 × 345 mm (19.8 × 12.5 × 13.6 in)
Net Weight, Loudspeaker with grille and bracket	16.1 kg (35.5 lb)
Shipping Weight	18.8 kg (41.5 lb)
Included Accessories	U-Bracket
Optional Accessories	None
<b>PRODUCT CODES</b>	
831856-0110	DESIGNMAX DM10S-SUB SINGLE BLK
831856-0210	DESIGNMAX DM10S-SUB SINGLE WHT

**Footnotes**

- (1) Frequency response and range measured on-axis in half-space environment with Bose EQ voicing
- (2) Sensitivity measured on-axis in half-space environment with Bose EQ voicing
- (3) Maximum SPL calculated from sensitivity and power handling specifications, exclusive of power compression.
- (4) Bose extended-lifecycle test using pink noise filtered to meet IEC268-5, 6-dB crest factor, 500-hour duration.
- (5) AES standard 2-hour duration with IEC system noise

For additional specifications and application information, please visit [PRO.BOSE.COM](http://PRO.BOSE.COM).  
 Specifications subject to change without notice. 11/2019

# DesignMax DM10S-SUB

surface-mounted subwoofer

## On-Axis Frequency Response (half-space (2 $\pi$ ) with Bose EQ voicing)

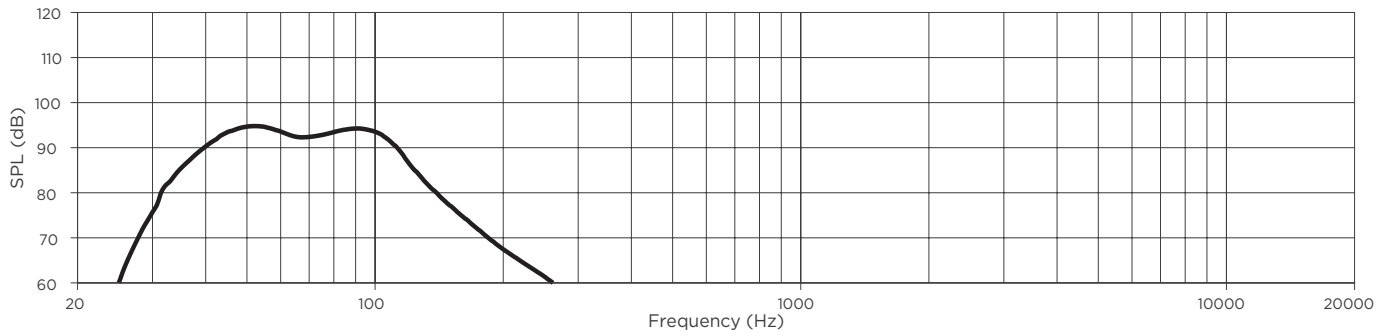

## Impedance

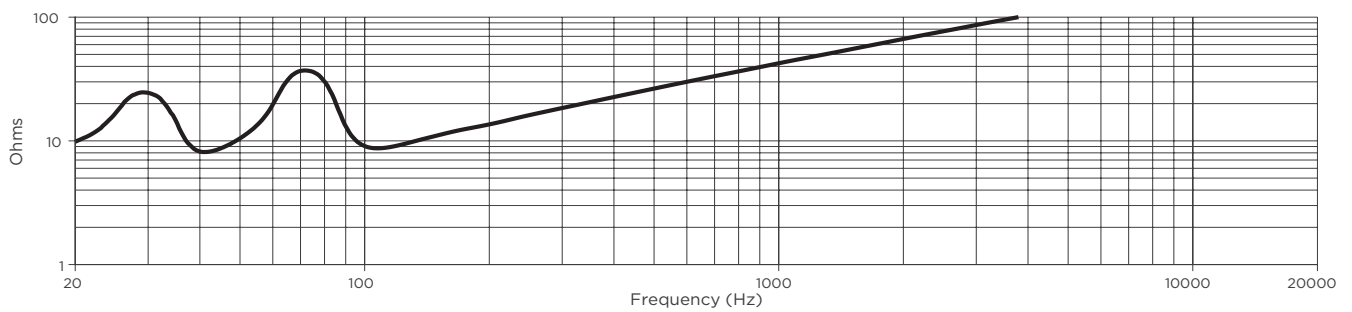

# DesignMax DM10S-SUB

## surface-mounted subwoofer

### Dimensions

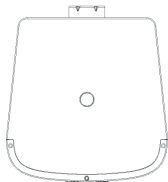

**Top View**  
BRACKET SHOWN IN  
REAR LOCATION

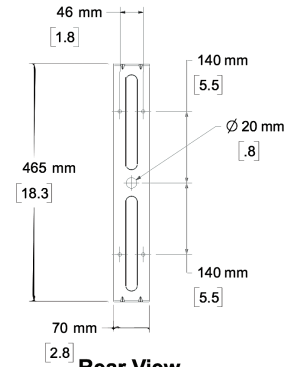
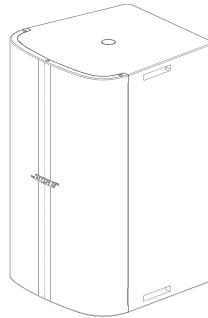

**Rear View**  
BRACKET ONLY

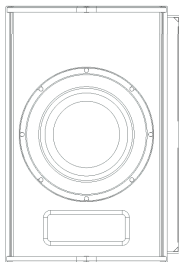

**Front View**  
GRILLE REMOVED FOR CLARITY  
BRACKET SHOWN IN  
SIDE LOCATION

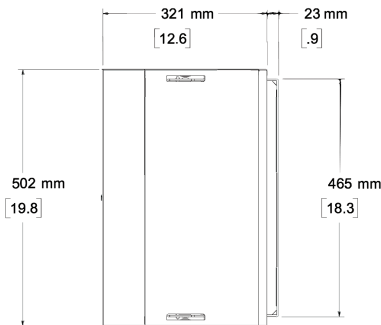

**Right View**  
DIMENSIONS APPLY TO BOTH SIDES  
BRACKET SHOWN IN REAR LOCATION

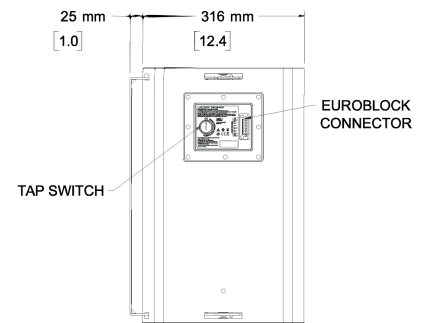

**Rear View**  
BRACKET SHOWN IN SIDE LOCATION

- NOTES:
1. DIMENSIONS ARE IN MILLIMETERS OVER INCHES
  2. WEIGHT 16.05kg [35.40lbs] (SPEAKER ONLY)  
WEIGHT W/BRACKET 16.07kg [35.45lbs]