

 Bluetooth

# BEACON

*Line Array*

- Reaches Crowds of 2500+
- Lightweight Array Tower has Eight 4" Neodymium Speakers
- Base has Three 8" Neodymium Subwoofers
- Up to Two Built-in UHF Wireless Receivers
- Comes with Standard Built-in Bluetooth
- Collapsible Sturdy Handle & Rugged Rolling Wheels
- Optional built-in CD/MP3 combo player

COMES WITH  
BUILT-IN  
BLUETOOTH

AnchorAudio.com

800.262.4671

SIX YEAR WARRANTY



MADE IN THE USA





The Beacon<sup>®</sup> is a battery powered portable sound system like no other. The Line Array Tower with eight 4" neodymium speakers can be opened in less than a minute. With the additional three 8" neodymium woofers in the base, full-range sound spreads evenly over any large crowd.

The Beacon offers user-friendly feature controls, standard built-in Bluetooth, optional built-in CD/MP3 combo player and up to two wireless microphones. The compact enclosure has a storage bag for microphones and a collapsable handle with rolling wheels.

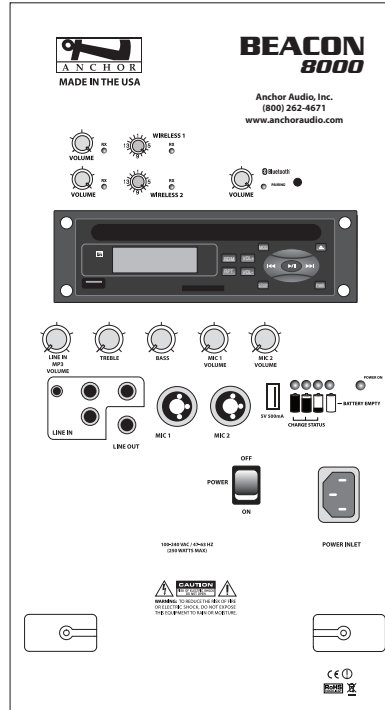

(BEA-8000CU2 Back Panel Shown)

### BEACON MODELS

BEA-8000	Beacon with Bluetooth
BEA-8000U1	Beacon with Bluetooth & 1 wireless receiver
BEA-8000U2	Beacon with Bluetooth & 2 wireless receivers
BEA-8000C	Beacon with Bluetooth & CD/MP3 combo player
BEA-8000CU1	Beacon with Bluetooth, CD/MP3 combo player & 1 wireless receiver
BEA-8000CU2	Beacon with Bluetooth, CD/MP3 combo player & 2 wireless receivers

### Features

- Reach Crowds of 2,500+
- AC Mode = 150W / DC Mode = 125W
- Eight 4" Neodymium Speakers
- Three 8" Neodymium Woofers
- True AC/DC - 110/220V Power Supply
- Two Universal Microphone Input Jacks
- Single or Dual Built-in UHF Wireless with 16 User Selectable Channels
- Comes with Standard Built-in Bluetooth
- Optional Built-In CD/MP3 Combo Player
- Remote Control for CD/MP3 Combo Player
- 3.5mm input for iPod<sup>®</sup>
- USB Port for Charging MP3/iPod
- Patented, Lightweight Speaker Array with Snap Lock Connection
- Durable Case with Wheels, Retractable Handle & Nylon Storage Bag
- Proprietary Class D Amplifier
- User Replaceable Batteries
- Charging LED Bar Indicator
- Operates 6-8 hours on a Single Charge
- No Stand Needed
- UV Treated / Fade Resistant Case

### UHF WIRELESS

- WH-8000 Wireless handheld microphone/transmitter (540-570 MHz)
- WB-8000 Wireless body-pack transmitter (540-570 MHz) (requires handsfree microphone) Microphone options include: Over-the-Ear/EM-TA4F, Lapel/LM-60, Collar/CM-60, Headband/HBM-TA4F

### TECHNICAL SPECIFICATIONS

Rated Power Output	150 watts AC / 125 watts DC	Microphone Inputs:	Lo-Z (1 K $\Omega$ ), balanced, XLR
Max SPL @ Rated Power	120 dB		12 VDC condenser mic (phantom) power
Battery	Two 12 V rechargeable, 9.0 AH Full recharge: approx 7 hrs		Hi-Z (10 K $\Omega$ ), unbalanced, 1/4" phone
Frequency Response	60 Hz - 15 kHz $\pm$ 3dB		Hi-Z (10 K $\Omega$ ), unbalanced, 1/8" stereo
Line Output (post fader)	isolated, 600 $\Omega$ , 1/4" phone	Line In	unbalanced, stereo RCA
AC Power Reqs.	100 - 240 VAC, 50/60 Hz, 300W max	Sensitivity For Rated Output	
USB	5V 500mA	Lo-Z Microphone	-52 dBV (2.5 mVrms)
Dimensions Closed (HWD)	28.5" x 18" x 12.5" (72 x 45 x 31cm)	Hi-Z Microphone	-43 dBV (7.5 mVrms)
Dimensions Opened (HWD)	71.5" x 18" x 12.5" (181 x 45 x 31cm)	Auxiliary (line)	-14 dBV (200 mVrms)
Weight	51 lbs / 23 Kg	Phantom Power	36V



(Features & Specifications Subject to Change Without Notice)